

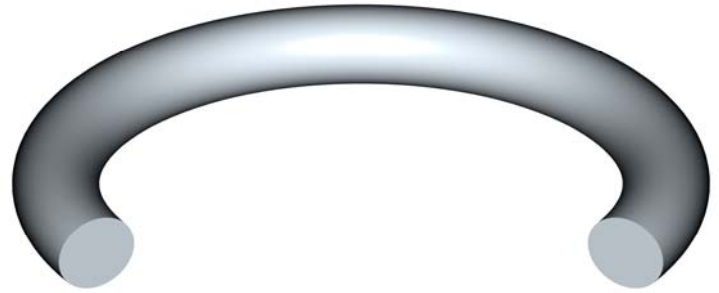

O-Rings





O-Rings

Standard Size



O-Rings first became popular during World War II. One of the early standards, AN6227, contained only 88 sizes. As the usefulness and flexibility of the O-Ring became apparent, additional standards were developed to expand the sizes available to the engineers of the day. Today, AS-568, containing 379 sizes is considered to be the O-Ring industry's standard.

The following 11 pages list the O-Rings that *Precision Associates* considers to be standard sizes. This list contains not only the AS-568 O-Rings, but our unique extended sizes. PAI has added these are O-Rings to the beginning and/or end of each Cross Section series. You will find 26 sizes added to the 400 series alone.

Our O-Rings are available in more than 900 compounds developed by PAI chemists to meet the challenging requirements of today's applications. Refer to our Compound Selection guide, or call us for help determining the material best suited for your application.

The dimensions and tolerances listed are per AS-568 and apply to our standard 70 Durometer Buna N. Due to the variations in shrink characteristics of rubber materials, design engineers should not assume that the dimensions and tolerances will apply to all materials. General shrink characteristics are available in PAI Technical Bulletin 111. When necessary, you may contact Precision Associates' Customer Service department to obtain the expected dimensions and tolerances for our other compounds.

If our Standard Size O-Rings will not meet your needs, be sure to check out our very large selection of Special Sizes starting on page 15 of this document.

Mold IDen	Nominal Dimensions			Actual Dimensions		
	ID	OD	C/S	ID	C/S	OD (Ref)
1-001	1/32	3/32	1/32	.029 ± .004	.040 ± .003	.109
40-70	5/64	9/64	1/32	.070 ± .005	.040	.150
1-002	3/64	9/64	3/64	.042 ± .004	.050	.142
1-003	1/16	11/64	1/16	.056	.060	.176
1-004	5/64	13/64	1/16	.070 ± .005	.070	.210
1-005	7/64	15/64	1/16	.101	.070	.241
1-006	1/8	1/4	1/16	.114	.070	.254
1-007	5/32	9/32	1/16	.145	.070	.285
1-008	3/16	5/16	1/16	.176	.070	.316
1-009	7/32	11/32	1/16	.208	.070	.348
1-010	1/4	3/8	1/16	.239	.070	.379
1-011	5/16	7/16	1/16	.301	.070	.441
1-012	3/8	1/2	1/16	.364	.070	.504
1-013	7/16	9/16	1/16	.426	.070	.566
1-014	1/2	5/8	1/16	.489	.070	.629
1-015	9/16	11/16	1/16	.551 ± .007	.070	.691
1-016	5/8	3/4	1/16	.614 ± .009	.070	.754
1-017	11/16	13/16	1/16	.676	.070	.816
1-018	3/4	7/8	1/16	.739	.070	.879
1-019	13/16	15/16	1/16	.801	.070	.941



O-Rings

Standard Size



Mold IDen	Nominal Dimensions			Actual Dimensions		
	ID	OD	C/S	ID	C/S	OD (Ref)
1-019	13/16	15/16	1/16	.801 ± .009	.070 ± .003	.941
1-020	7/8	1	1/16	.864	.070	1.004
1-021	15/16	1 1/16	1/16	.926	.070	1.066
1-022	1	1 1/8	1/16	.989 ± .010	.070	1.129
1-023	1 1/16	1 3/16	1/16	1.051	.070	1.191
1-024	1 1/8	1 1/4	1/16	1.114	.070	1.254
1-025	1 3/16	1 5/16	1/16	1.176	.070	1.316
1-026	1 1/4	1 3/8	1/16	1.239	.070	1.379
1-027	1 5/16	1 7/16	1/16	1.301	.070	1.441
1-028	1 3/8	1 1/2	1/16	1.364 ± .013	.070	1.504
1-029	1 1/2	1 5/8	1/16	1.489	.070	1.629
1-030	1 5/8	1 3/4	1/16	1.614	.070	1.754
1-031	1 3/4	1 7/8	1/16	1.739 ± .015	.070	1.879
1-032	1 7/8	2	1/16	1.864	.070	2.004
1-033	2	2 1/8	1/16	1.989 ± .018	.070	2.129
1-034	2 1/8	2 1/4	1/16	2.114	.070	2.254
1-035	2 1/4	2 3/8	1/16	2.239	.070	2.379
1-036	2 3/8	2 1/2	1/16	2.364	.070	2.504
1-037	2 1/2	2 5/8	1/16	2.489	.070	2.629
1-038	2 5/8	2 3/4	1/16	2.614 ± .020	.070	2.754
1-039	2 3/4	2 7/8	1/16	2.739	.070	2.879
1-040	2 7/8	3	1/16	2.864	.070	3.004
1-041	3	3 1/8	1/16	2.989 ± .024	.070	3.129
1-042	3 1/4	3 3/8	1/16	3.239	.070	3.379
1-043	3 1/2	3 5/8	1/16	3.489	.070	3.629
1-044	3 3/4	3 7/8	1/16	3.739 ± .027	.070	3.879
1-045	4	4 1/8	1/16	3.989	.070	4.129
1-046	4 1/4	4 3/8	1/16	4.239 ± .030	.070	4.379
1-047	4 1/2	4 5/8	1/16	4.489	.070	4.629
1-048	4 3/4	4 7/8	1/16	4.739	.070	4.879
1-049	5	5 1/8	1/16	4.989 ± .037	.070	5.129
1-050	5 1/4	5 3/8	1/16	5.239	.070	5.379
1-051	5 1/2	5 5/8	1/16	5.489	.070	5.629
1-052	5 3/4	5 7/8	1/16	5.739	.070	5.879
1-053	6	6 1/8	1/16	5.989	.070	6.129
1-054	6 1/4	6 3/8	1/16	6.239 ± .040	.070	6.379
1-055	6 1/2	6 5/8	1/16	6.489	.070	6.629
1-056	6 3/4	6 7/8	1/16	6.739	.070	6.879
1-057	7	7 1/8	1/16	6.989	.070	7.129
1-058	7 1/4	7 3/8	1/16	7.239 ± .045	.070	7.379
1-059	7 1/2	7 5/8	1/16	7.489	.070	7.629
1-060	7 3/4	7 7/8	1/16	7.739	.070	7.879
1-061	8	8 1/8	1/16	7.989	.070	8.129



O-Rings

Standard Size



Mold IDen	Nominal Dimensions			Actual Dimensions		
	ID	OD	C/S	ID	C/S	OD (Ref)
1-102	1/16	1/4	3/32	.050 ± .005	.103 ± .003	0.256
1-103	3/32	9/32	3/32	.081	.103	0.287
1-104	1/8	5/16	3/32	.112	.103	0.318
1-105	5/32	11/32	3/32	.143	.103	0.349
1-106	3/16	3/8	3/32	.175	.103	0.381
1-107	7/32	13/32	3/32	.206	.103	0.412
1-108	1/4	7/16	3/32	.237	.103	0.443
1-109	5/16	1/2	3/32	.299	.103	0.505
1-110	3/8	9/16	3/32	.362	.103	0.568
1-111	7/16	5/8	3/32	.424	.103	0.630
1-112	1/2	11/16	3/32	.487	.103	0.693
1-113	9/16	3/4	3/32	.549 ± .007	.103	0.755
1-114	5/8	13/16	3/32	.612 ± .009	.103	0.818
1-115	11/16	7/8	3/32	.674	.103	0.880
1-116	3/4	15/16	3/32	.737	.103	0.943
1-117	13/16	1	3/32	.799 ± .010	.103	1.005
1-118	7/8	1 1/16	3/32	.862	.103	1.068
1-119	15/16	1 1/8	3/32	.924	.103	1.130
1-120	1	1 3/16	3/32	.987	.103	1.193
1-121	1 1/16	1 1/4	3/32	1.049	.103	1.255
1-122	1 1/8	1 5/16	3/32	1.112	.103	1.318
1-123	1 3/16	1 3/8	3/32	1.174 ± .012	.103	1.380
1-124	1 1/4	1 7/16	3/32	1.237	.103	1.443
1-125	1 5/16	1 1/2	3/32	1.299	.103	1.505
1-126	1 3/8	1 9/16	3/32	1.362	.103	1.568
1-127	1 7/16	1 5/8	3/32	1.424	.103	1.630
1-128	1 1/2	1 11/16	3/32	1.487	.103	1.693
1-129	1 9/16	1 3/4	3/32	1.549 ± .015	.103	1.755
1-130	1 5/8	1 13/16	3/32	1.612	.103	1.818
1-131	1 11/16	1 7/8	3/32	1.674	.103	1.880
1-132	1 3/4	1 15/16	3/32	1.737	.103	1.943
1-133	1 13/16	2	3/32	1.799	.103	2.005
1-134	1 7/8	2 1/16	3/32	1.862	.103	2.068
1-135	1 15/16	2 1/8	3/32	1.925 ± .017	.103	2.131
1-136	2	2 3/16	3/32	1.987	.103	2.193
1-137	2 1/16	2 1/4	3/32	2.050	.103	2.256
1-138	2 1/8	2 5/16	3/32	2.112	.103	2.318
1-139	2 3/16	2 3/8	3/32	2.175	.103	2.381
1-140	2 1/4	2 7/16	3/32	2.237	.103	2.443
1-141	2 5/16	2 1/2	3/32	2.300 ± .020	.103	2.506
1-142	2 3/8	2 9/16	3/32	2.362	.103	2.568
1-143	2 7/16	2 5/8	3/32	2.425	.103	2.631
1-144	2 1/2	2 11/16	3/32	2.487	.103	2.693



O-Rings

Standard Size



Mold IDen	Nominal Dimensions			Actual Dimensions		
	ID	OD	C/S	ID	C/S	OD (Ref)
1-145	2 9/16	2 3/4	3/32	2.550 ± .020	.103 ± .003	2.756
1-146	2 5/8	2 13/16	3/32	2.612 ±	.103	2.818
1-147	2 11/16	2 7/8	3/32	2.675 ± .022	.103	2.881
1-148	2 3/4	2 15/16	3/32	2.737 ±	.103	2.943
1-149	2 13/16	3	3/32	2.800 ±	.103	3.006
1-150	2 7/8	3 1/16	3/32	2.862 ±	.103	3.068
1-151	3	3 3/16	3/32	2.987 ± .024	.103	3.193
1-152	3 1/4	3 7/16	3/32	3.237 ±	.103	3.443
1-153	3 1/2	3 11/16	3/32	3.487 ±	.103	3.693
1-154	3 3/4	3 15/16	3/32	3.737 ± .028	.103	3.943
1-155	4	4 3/16	3/32	3.987 ±	.103	4.193
1-156	4 1/4	4 7/16	3/32	4.237 ± .030	.103	4.443
1-157	4 1/2	4 11/16	3/32	4.487 ±	.103	4.693
1-158	4 3/4	4 15/16	3/32	4.737 ±	.103	4.943
1-159	5	5 3/16	3/32	4.987 ± .035	.103	5.193
1-160	5 1/4	5 7/16	3/32	5.237 ±	.103	5.443
1-161	5 1/2	5 11/16	3/32	5.487 ±	.103	5.693
1-162	5 3/4	5 15/16	3/32	5.737 ±	.103	5.943
1-163	6	6 3/16	3/32	5.987 ±	.103	6.193
1-164	6 1/4	6 7/16	3/32	6.237 ± .040	.103	6.443
1-165	6 1/2	6 11/16	3/32	6.487 ±	.103	6.693
1-166	6 3/4	6 15/16	3/32	6.737 ±	.103	6.943
1-167	7	7 3/16	3/32	6.987 ±	.103	7.193
1-168	7 1/4	7 7/16	3/32	7.237 ± .045	.103	7.443
1-169	7 1/2	7 11/16	3/32	7.487 ±	.103	7.693
1-170	7 3/4	7 15/16	3/32	7.737 ±	.103	7.943
1-171	8	8 3/16	3/32	7.987 ±	.103	8.193
1-172	8 1/4	8 7/16	3/32	8.237 ± .050	.103	8.443
1-173	8 1/2	8 11/16	3/32	8.487 ±	.103	8.693
1-174	8 3/4	8 15/16	3/32	8.737 ±	.103	8.943
1-175	9	9 3/16	3/32	8.987 ±	.103	9.193
1-176	9 1/4	9 7/16	3/32	9.237 ± .055	.103	9.443
1-177	9 1/2	9 11/16	3/32	9.487 ±	.103	9.693
1-178	9 3/4	9 15/16	3/32	9.737 ±	.103	9.943
1-179	10	10 3/16	3/32	9.987 ±	.103	10.193



O-Rings

Standard Size



Mold IDen	Nominal Dimensions			Actual Dimensions		
	ID	OD	C/S	ID	C/S	OD (Ref)
1-201	3/16	7/16	1/8	0.171 ± .005	.139 ± .004	0.449
1-202	1/4	1/2	1/8	0.234	.139	0.512
1-203	5/16	9/16	1/8	0.301	.139	0.579
1-204	3/8	5/8	1/8	0.359	.139	0.637
1-205	7/16	11/16	1/8	0.421	.139	0.699
1-206	1/2	3/4	1/8	0.484	.139	0.762
1-207	9/16	13/16	1/8	0.549 ± .007	.139	0.827
1-208	5/8	7/8	1/8	0.609 ± .009	.139	0.887
1-209	11/16	15/16	1/8	.672	.139	0.950
1-210	3/4	1	1/8	.734 ± .010	.139	1.012
1-211	13/16	1 1/16	1/8	.796	.139	1.074
1-212	7/8	1 1/8	1/8	.859	.139	1.137
1-213	15/16	1 3/16	1/8	.921	.139	1.199
1-214	1	1 1/4	1/8	.984	.139	1.262
1-215	1 1/16	1 5/16	1/8	1.046	.139	1.324
1-216	1 1/8	1 3/8	1/8	1.109 ± .012	.139	1.387
1-217	1 3/16	1 7/16	1/8	1.171	.139	1.449
1-218	1 1/4	1 1/2	1/8	1.234	.139	1.512
1-219	1 5/16	1 9/16	1/8	1.296	.139	1.574
1-220	1 3/8	1 5/8	1/8	1.359	.139	1.637
1-221	1 7/16	1 11/16	1/8	1.421	.139	1.699
1-222	1 1/2	1 3/4	1/8	1.484 ± .015	.139	1.762
1-223	1 5/8	1 7/8	1/8	1.609	.139	1.887
1-224	1 3/4	2	1/8	1.734	.139	2.012
1-225	1 7/8	2 1/8	1/8	1.859 ± .018	.139	2.137
1-226	2	2 1/4	1/8	1.984	.139	2.262
1-227	2 1/8	2 3/8	1/8	2.109	.139	2.387
1-228	2 1/4	2 1/2	1/8	2.234 ± .020	.139	2.512
1-229	2 3/8	2 5/8	1/8	2.359	.139	2.637
1-230	2 1/2	2 3/4	1/8	2.484	.139	2.762
1-231	2 5/8	2 7/8	1/8	2.609	.139	2.887
1-232	2 3/4	3	1/8	2.734 ± .024	.139	3.012
1-233	2 7/8	3 1/8	1/8	2.859	.139	3.137
1-234	3	3 1/4	1/8	2.984	.139	3.262
1-235	3 1/8	3 3/8	1/8	3.109	.139	3.387
1-236	3 1/4	3 1/2	1/8	3.234	.139	3.512
1-237	3 3/8	3 5/8	1/8	3.359	.139	3.637
1-238	3 1/2	3 3/4	1/8	3.484	.139	3.762
1-239	3 5/8	3 7/8	1/8	3.609 ± .028	.139	3.887
1-240	3 3/4	4	1/8	3.734	.139	4.012
1-241	3 7/8	4 1/8	1/8	3.859	.139	4.137
1-242	4	4 1/4	1/8	3.984	.139	4.262
1-243	4 1/8	4 3/8	1/8	4.109	.139	4.387



O-Rings

Standard Size



Mold IDen	Nominal Dimensions			Actual Dimensions		
	ID	OD	C/S	ID	C/S	OD (Ref)
1-244	4 1/4	4 1/2	1/8	4.234 ± .030	.139 ± .004	4.512
1-245	4 3/8	4 5/8	1/8	4.359	.139	4.637
1-246	4 1/2	4 3/4	1/8	4.484	.139	4.762
1-247	4 5/8	4 7/8	1/8	4.609	.139	4.887
1-248	4 3/4	5	1/8	4.734	.139	5.012
1-249	4 7/8	5 1/8	1/8	4.859 ± .035	.139	5.137
1-250	5	5 1/4	1/8	4.984	.139	5.262
1-251	5 1/8	5 3/8	1/8	5.109	.139	5.387
1-252	5 1/4	5 1/2	1/8	5.234	.139	5.512
1-253	5 3/8	5 5/8	1/8	5.359	.139	5.637
1-254	5 1/2	5 3/4	1/8	5.484	.139	5.762
1-255	5 5/8	5 7/8	1/8	5.609	.139	5.887
1-256	5 3/4	6	1/8	5.734	.139	6.012
1-257	5 7/8	6 1/8	1/8	5.859	.139	6.137
1-258	6	6 1/4	1/8	5.984	.139	6.262
1-259	6 1/4	6 1/2	1/8	6.234 ± .040	.139	6.512
1-260	6 1/2	6 3/4	1/8	6.484	.139	6.762
1-261	6 3/4	7	1/8	6.734	.139	7.012
1-262	7	7 1/4	1/8	6.984 ±	.139	7.262
1-263	7 1/4	7 1/2	1/8	7.234 ± .045	.139	7.512
1-264	7 1/2	7 3/4	1/8	7.484	.139	7.762
1-265	7 3/4	8	1/8	7.734	.139	8.012
1-266	8	8 1/4	1/8	7.984	.139	8.262
1-267	8 1/4	8 1/2	1/8	8.234 ± .050	.139	8.512
1-268	8 1/2	8 3/4	1/8	8.484	.139	8.762
1-269	8 3/4	9	1/8	8.734	.139	9.012
1-270	9	9 1/4	1/8	8.984	.139	9.262
1-271	9 1/4	9 1/2	1/8	9.234 ± .055	.139	9.512
1-272	9 1/2	9 3/4	1/8	9.484	.139	9.762
1-273	9 3/4	10	1/8	9.734	.139	10.012
1-274	10	10 1/4	1/8	9.984	.139	10.262
1-275	10 1/2	10 3/4	1/8	10.484	.139	10.762
1-276	11	11 1/4	1/8	10.984 ± .065	.139	11.262
1-277	11 1/2	11 3/4	1/8	11.484	.139	11.762
1-278	12	12 1/4	1/8	11.984	.139	12.262
1-279	13	13 1/4	1/8	12.984	.139	13.262
1-280	14	14 1/4	1/8	13.984	.139	14.262
1-281	15	15 1/4	1/8	14.984	.139	15.262
1-282	16	16 1/4	1/8	15.955 ± .075	.139	16.233
1-283	17	17 1/4	1/8	16.955 ± .080	.139	17.233
1-284	18	18 1/4	1/8	17.955 ± .085	.139	18.233
1-286	20	20 1/4	1/8	19.960 ± .090	.139	20.238



O-Rings

Standard Size



Mold IDen	Nominal Dimensions			Actual Dimensions		
	ID	OD	C/S	ID	C/S	OD (Ref)
1-514	1	1 5/16	5/32	.975 ± .010	.176 ± .005	1.327
1-515	1 1/16	1 3/8	5/32	1.038	.176	1.390
1-516	1 1/8	1 7/16	5/32	1.100 ± .012	.176	1.452
1-517	1 3/16	1 1/2	5/32	1.163	.176	1.515
1-518	1 1/4	1 9/16	5/32	1.225	.176	1.577
1-519	1 5/16	1 5/8	5/32	1.288	.176	1.640
1-520	1 3/8	1 11/16	5/32	1.350	.176	1.702
1-521	1 7/16	1 3/4	5/32	1.413	.176	1.765
1-522	1 1/2	1 13/16	5/32	1.475 ± .015	.176	1.827
1-524	1 5/8	1 15/16	5/32	1.600	.176	1.952
1-526	1 3/4	2 1/16	5/32	1.725	.176	2.077
1-528	1 7/8	2 3/16	5/32	1.850	.176	2.202
1-530	2	2 5/16	5/32	1.975 ± .018	.176	2.327
1-532	2 1/8	2 7/16	5/32	2.100	.176	2.452
1-534	2 1/4	2 9/16	5/32	2.225	.176	2.577
1-536	2 3/8	2 11/16	5/32	2.350	.176	2.702
1-538	2 1/2	2 13/16	5/32	2.475 ± .020	.176	2.827
1-540	2 5/8	2 15/16	5/32	2.600	.176	2.952
1-542	2 3/4	3 1/16	5/32	2.725	.176	3.077
1-544	2 7/8	3 3/16	5/32	2.850	.176	3.202
1-546	3	3 5/16	5/32	2.975 ± .024	.176	3.327
1-548	3 1/8	3 7/16	5/32	3.100	.176	3.452
1-550	3 1/4	3 9/16	5/32	3.225	.176	3.577
1-552	3 3/8	3 11/16	5/32	3.350	.176	3.702
1-554	3 1/2	3 13/16	5/32	3.475	.176	3.827
1-556	3 5/8	3 15/16	5/32	3.600 ± .028	.176	3.952
1-558	3 3/4	4 1/16	5/32	3.725	.176	4.077
1-560	3 7/8	4 3/16	5/32	3.850	.176	4.202
1-562	4	4 5/16	5/32	3.975	.176	4.327
1-563	4 1/8	4 7/16	5/32	4.100	.176	4.452
1-565	4 1/4	4 9/16	5/32	4.225 ± .030	.176	4.577
1-566	4 3/8	4 11/16	5/32	4.350	.176	4.702
1-568	4 1/2	4 13/16	5/32	4.475	.176	4.827
1-569	4 5/8	4 15/16	5/32	4.600	.176	4.952
1-571	4 3/4	5 1/16	5/32	4.725	.176	5.077
1-572	4 7/8	5 3/16	5/32	4.850	.176	5.202



O-Rings

Standard Size



Mold IDen	Nominal Dimensions			Actual Dimensions		
	ID	OD	C/S	ID	C/S	OD (Ref)
1-308	3/8	3/4	3/16	.350 ± .005	0.210 ± .005	0.770
1-309	7/16	13/16	3/16	.412	0.210	0.832
1-310	1/2	7/8	3/16	.475	0.210	0.895
1-311	9/16	15/16	3/16	.537 ± .007	0.210	0.959
1-312	5/8	1	3/16	.600 ± .009	0.210	1.022
1-313	11/16	1 1/16	3/16	.662	0.210	1.084
1-314	3/4	1 1/8	3/16	.725 ± .010	0.210	1.147
1-315	13/16	1 3/16	3/16	.787	0.210	1.209
1-316	7/8	1 1/4	3/16	.850	0.210	1.272
1-317	15/16	1 5/16	3/16	.912 ± .010	0.210	1.334
1-318	1	1 3/8	3/16	.975	0.210	1.395
1-319	1 1/16	1 7/16	3/16	1.037	0.210	1.457
1-320	1 1/8	1 1/2	3/16	1.100 ± .012	0.210	1.520
1-321	1 3/16	1 9/16	3/16	1.162	0.210	1.582
1-322	1 1/4	1 5/8	3/16	1.225	0.210	1.645
1-323	1 5/16	1 11/16	3/16	1.287	0.210	1.707
1-324	1 3/8	1 3/4	3/16	1.350	0.210	1.770
1-325	1 1/2	1 7/8	3/16	1.475 ± .015	0.210	1.895
1-326	1 5/8	2	3/16	1.600	0.210	2.020
1-327	1 3/4	2 1/8	3/16	1.725	0.210	2.145
1-328	1 7/8	2 1/4	3/16	1.850	0.210	2.270
1-329	2	2 3/8	3/16	1.975 ± .018	0.210	2.395
1-330	2 1/8	2 1/2	3/16	2.100	0.210	2.520
1-331	2 1/4	2 5/8	3/16	2.225	0.210	2.645
1-332	2 3/8	2 3/4	3/16	2.350	0.210	2.770
1-333	2 1/2	2 7/8	3/16	2.475 ± .020	0.210	2.895
1-334	2 5/8	3	3/16	2.600	0.210	3.020
1-335	2 3/4	3 1/8	3/16	2.725	0.210	3.145
1-336	2 7/8	3 1/4	3/16	2.850	0.210	3.270
1-337	3	3 3/8	3/16	2.975 ± .024	0.210	3.395
1-338	3 1/8	3 1/2	3/16	3.100	0.210	3.520
1-339	3 1/4	3 5/8	3/16	3.225	0.210	3.645
1-340	3 3/8	3 3/4	3/16	3.350	0.210	3.770
1-341	3 1/2	3 7/8	3/16	3.475	0.210	3.895
1-342	3 5/8	4	3/16	3.600 ± .028	0.210	4.020
1-343	3 3/4	4 1/8	3/16	3.725	0.210	4.145
1-344	3 7/8	4 1/4	3/16	3.850	0.210	4.270
1-345	4	4 3/8	3/16	3.975	0.210	4.395
1-346	4 1/8	4 1/2	3/16	4.100	0.210	4.520
1-347	4 1/4	4 5/8	3/16	4.225 ± .030	0.210	4.645
1-348	4 3/8	4 3/4	3/16	4.350	0.210	4.770
1-349	4 1/2	4 7/8	3/16	4.475	0.210	4.895
1-350	4 5/8	5	3/16	4.600	0.210	5.020
1-351	4 3/4	5 1/8	3/16	4.725	0.210	5.145
1-352	4 7/8	5 1/4	3/16	4.850 ± .037	0.210	5.270

Precision Associates, Inc.
740 N. Washington Ave.
Minneapolis, MN 55401

Phone: 612-333-7464
Fax: 612-342-2417
Toll: 800-394-6590

www.PrecisionAssoc.com



O-Rings

Standard Size



Mold IDen	Nominal Dimensions			Actual Dimensions		
	ID	OD	C/S	ID	C/S	OD (Ref)
1-353	5	5 3/8	3/16	4.975 ± .037	0.210 ± .005	5.395
1-354	5 1/8	5 1/2	3/16	5.100	0.210	5.520
1-355	5 1/4	5 5/8	3/16	5.225	0.210	5.645
1-356	5 3/8	5 3/4	3/16	5.350	0.210	5.770
1-357	5 1/2	5 7/8	3/16	5.475	0.210	5.895
1-358	5 5/8	6	3/16	5.600	0.210	6.020
1-359	5 3/4	6 1/8	3/16	5.725	0.210	6.145
1-360	5 7/8	6 1/4	3/16	5.850 ± .037	0.210	6.270
1-361	6	6 3/8	3/16	5.975	0.210	6.395
1-362	6 1/4	6 5/8	3/16	6.225 ± .040	0.210	6.645
1-363	6 1/2	6 7/8	3/16	6.475	0.210	6.895
1-364	6 3/4	7 1/8	3/16	6.725	0.210	7.145
1-365	7	7 3/8	3/16	6.975	0.210	7.395
1-366	7 1/4	7 5/8	3/16	7.225 ± .045	0.210	7.645
1-367	7 1/2	7 7/8	3/16	7.475	0.210	7.895
1-368	7 3/4	8 1/8	3/16	7.725	0.210	8.145
1-369	8	8 3/8	3/16	7.975	0.210	8.395
1-370	8 1/4	8 5/8	3/16	8.225 ± .050	0.210	8.645
1-371	8 1/2	8 7/8	3/16	8.475	0.210	8.895
1-372	8 3/4	9 1/8	3/16	8.725	0.210	9.145
1-373	9	9 3/8	3/16	8.975	0.210	9.395
1-374	9 1/4	9 5/8	3/16	9.225 ± .055	0.210	9.645
1-375	9 1/2	9 7/8	3/16	9.475	0.210	9.895
1-376	9 3/4	10 1/8	3/16	9.725	0.210	10.145
1-377	10	10 3/8	3/16	9.975	0.210	10.395
1-378	10 1/2	10 7/8	3/16	10.475 ± .060	0.210	10.895
1-379	11	11 3/8	3/16	10.975	0.210	11.395
1-380	11 1/2	11 7/8	3/16	11.475 ± .065	0.210	11.895
1-381	12	12 3/8	3/16	11.975	0.210	12.395
1-382	13	13 3/8	3/16	12.975	0.210	13.395
1-383	14	14 3/8	3/16	13.975 ± .070	0.210	14.395
1-384	15	15 3/8	3/16	14.975	0.210	15.395
1-385	16	16 3/8	3/16	15.955	0.210	16.375
1-386	17	17 3/8	3/16	16.955 ± .080	0.210	17.375
1-387	18	18 3/8	3/16	17.955 ± .085	0.210	18.375
1-388	19	19 3/8	3/16	18.955 ± .090	0.210	19.375
1-389	20	20 3/8	3/16	19.955 ± .095	0.210	20.375
1-390	21	21 3/8	3/16	20.955	0.210	21.375
1-391	22	22 3/8	3/16	21.955	0.210	22.373
1-392	23	23 3/8	3/16	22.940 ± .105	0.210	23.360
1-393	24	24 3/8	3/16	23.940 ± .110	0.210	24.360
1-394	25	25 3/8	3/16	24.940 ± .115	0.210	25.360
1-395	26	26 3/8	3/16	25.940 ± .120	0.210	26.360
1-396	27	27 3/8	3/16	26.965	0.210	27.385



O-Rings

Standard Size



Mold IDen	Nominal Dimensions			Actual Dimensions		
	ID	OD	C/S	ID	C/S	OD (Ref)
1-400	1 3/8	1 7/8	1/4	1.350 ± .012	.275 ± .006	1.900
1-401	1 1/2	2	1/4	1.475 ± .015	.275	2.025
1-402	1 5/8	2 1/8	1/4	1.600	.275	2.150
1-403	1 3/4	2 1/4	1/4	1.725	.275	2.275
1-404	1 7/8	2 3/8	1/4	1.850	.275	2.400
1-405	2	2 1/2	1/4	1.975 ± .018	.275	2.525
1-406	2 1/8	2 5/8	1/4	2.100 ± .018	.275	2.650
1-407	2 1/4	2 3/4	1/4	2.225	.275	2.775
1-408	2 3/8	2 7/8	1/4	2.350	.275	2.900
1-409	2 1/2	3	1/4	2.475 ± .020	.275	3.025
1-410	2 5/8	3 1/8	1/4	2.600	.275	3.150
1-411	2 3/4	3 1/4	1/4	2.725	.275	3.275
1-412	2 7/8	3 3/8	1/4	2.850	.275	3.400
1-413	3	3 1/2	1/4	2.975 ± .024	.275	3.525
1-414	3 1/8	3 5/8	1/4	3.100	.275	3.650
1-415	3 1/4	3 3/4	1/4	3.225	.275	3.775
1-416	3 3/8	3 7/8	1/4	3.350	.275	3.900
1-417	3 1/2	4	1/4	3.475	.275	4.025
1-418	3 5/8	4 1/8	1/4	3.600 ± .028	.275	4.150
1-419	3 3/4	4 1/4	1/4	3.725	.275	4.275
1-420	3 7/8	4 3/8	1/4	3.850	.275	4.400
1-421	4	4 1/2	1/4	3.975	.275	4.525
1-422	4 1/8	4 5/8	1/4	4.100	.275	4.650
1-423	4 1/4	4 3/4	1/4	4.225 ± .030	.275	4.775
1-424	4 3/8	4 7/8	1/4	4.350	.275	4.900
1-425	4 1/2	5	1/4	4.475 ± .033	.275	5.025
1-426	4 5/8	5 1/8	1/4	4.600	.275	5.150
1-427	4 3/4	5 1/4	1/4	4.725	.275	5.275
1-428	4 7/8	5 3/8	1/4	4.850	.275	5.400
1-429	5	5 1/2	1/4	4.975 ± .037	.275	5.525
1-430	5 1/8	5 5/8	1/4	5.100	.275	5.650
1-431	5 1/4	5 3/4	1/4	5.225	.275	5.775
1-432	5 3/8	5 7/8	1/4	5.350	.275	5.900
1-433	5 1/2	6	1/4	5.475	.275	6.025
1-434	5 5/8	6 1/8	1/4	5.600	.275	6.150
1-435	5 3/4	6 1/4	1/4	5.725	.275	6.275
1-436	5 7/8	6 3/8	1/4	5.850	.275	6.400
1-437	6	6 1/2	1/4	5.975	.275	6.525
1-438	6 1/4	6 3/4	1/4	6.225 ± .040	.275	6.775
1-439	6 1/2	7	1/4	6.475	.275	7.025
1-440	6 3/4	7 1/4	1/4	6.725	.275	7.275
1-441	7	7 1/2	1/4	6.975	.275	7.525
1-442	7 1/4	7 3/4	1/4	7.225 ± .045	.275	7.775

Precision Associates, Inc.
740 N. Washington Ave.
Minneapolis, MN 55401

Phone: 612-333-7464
Fax: 612-342-2417
Toll: 800-394-6590

www.PrecisionAssoc.com



O-Rings

Standard Size



Mold IDen	Nominal Dimensions			Actual Dimensions		
	ID	OD	C/S	ID	C/S	OD (Ref)
1-443	7 1/2	8	1/4	7.475 ± .045	.275 ± .006	8.025
1-444	7 3/4	8 1/4	1/4	7.725	.275	8.275
1-445	8	8 1/2	1/4	7.975	.275	8.525
1-446	8 1/2	9	1/4	8.475 ± .055	.275	9.025
1-447	9	9 1/2	1/4	8.975	.275	9.525
1-448	9 1/2	10	1/4	9.475	.275	10.025
1-449	10	10 1/2	1/4	9.975 ± .055	.275	10.525
1-450	10 1/2	11	1/4	10.475 ± .060	.275	11.025
1-451	11	11 1/2	1/4	10.975	.275	11.525
1-452	11 1/2	12	1/4	11.475	.275	12.025
1-453	12	12 1/2	1/4	11.975	.275	12.525
1-454	12 1/2	13	1/4	12.475	.275	13.025
1-455	13	13 1/2	1/4	12.975	.275	13.525
1-456	13 1/2	14	1/4	13.475 ± .070	.275	14.025
1-457	14	14 1/2	1/4	13.975	.275	14.525
1-458	14 1/2	15	1/4	14.475	.275	15.025
1-459	15	15 1/2	1/4	14.975	.275	15.525
1-460	15 1/2	16	1/4	15.475	.275	16.025
1-461	16	16 1/2	1/4	15.955 ± .075	.275	16.505
1-462	16 1/2	17	1/4	16.455	.275	17.005
1-463	17	17 1/2	1/4	16.955 ± .080	.275	17.505
1-464	17 1/2	18	1/4	17.455 ± .085	.275	18.005
1-465	18	18 1/2	1/4	17.955	.275	18.505
1-466	18 1/2	19	1/4	18.455	.275	19.005
1-467	19	19 1/2	1/4	18.955 ± .090	.275	19.505
1-468	19 1/2	20	1/4	19.455	.275	20.005
1-469	20	20 1/2	1/4	19.955 ± .095	.275	20.505
1-470	21	21 1/2	1/4	20.955	.275	21.505
1-471	22	22 1/2	1/4	21.955 ± .100	.275	22.505
1-472	23	23 1/2	1/4	22.940 ± .105	.275	23.490
1-473	24	24 1/2	1/4	23.940 ± .110	.275	24.490
1-474	25	25 1/2	1/4	24.940 ± .115	.275	25.490
1-475	26	26 1/2	1/4	25.940 ± .120	.275	26.490
1-476	27	27 1/2	1/4	26.955	.275	27.505



O-Rings

Tube & Boss



Mold IDen	Tube Size	Actual Dimensions		
		ID	C/S	OD (Ref)
1-901	3/32	.185 ± .005	.056 ± .003	0.297
1-902	1/8	.239 ±	.064	0.367
1-903	3/16	.301 ±	.064	0.429
1-904	1/4	.351 ±	.072	0.495
1-905	5/16	.414 ±	.072	0.558
1-906	3/8	.468 ±	.078	0.624
1-907	7/16	.530 ±	.082	0.694
1-908	1/2	.644 ± .009	.087	0.818
1-909	9/16	.706 ±	.097	0.900
1-910	5/8	.755 ±	.097	0.949
1-911	11/16	.863 ± .010	.116 ± .004	1.095
1-912	3/4	.924 ±	.116	1.156
1-913	13/16	.986 ±	.116	1.218
1-914	7/8	1.047 ±	.116	1.279
1-915	15/16	1.109 ± .012	.116	1.341
1-916	1	1.171 ±	.116	1.403
1-918	1 1/8	1.355 ±	.116	1.587
1-920	1 1/4	1.475 ±	.118	1.711
1-924	1 1/2	1.720 ± .015	.118	1.956
1-928	1 3/4	2.090 ± .018	.118	2.326
1-932	2	2.337 ± .020	.118	2.573



O-Rings Standard Size



Back by popular demand! Precision Associates has re-created the full size line drawings of our standard O-Rings. Samples of 1/8" and 5/32" Cross Sections are shown below. Call customer service to request your copy, or download a set today from our websites at: <http://www.PrecisionAssoc.com> or <http://www.PAICustomers.com>.

O-Rings Standard Size 1/8 Cross Section

Mold IDem	Nominal Dimensions			Actual Dimensions		O.D. (Ref)	Specification
	I.D.	O.D.	C/S	I.D.	C/S		
1-201	3/16	7/16	1/8	.171 ± .005	.139 ± .004	.449	AS568-201
1-202	1/4	1/2	1/8	.234	.139	.512	AS568-202
1-203	5/16	9/16	1/8	.301	.139	.579	AS568-203
1-204	3/8	5/8	1/8	.369	.139	.637	AS568-204
1-205	7/16	11/16	1/8	.421	.139	.699	AS568-205
1-206	1/2	3/4	1/8	.494	.139	.762	AS568-206
1-207	9/16	13/16	1/8	.549 ± .007	.139	.827	AS568-207
1-208	5/8	7/8	1/8	.609 ± .009	.139	.887	AS568-208
1-209	11/16	15/16	1/8	.672	.139	.950	AS568-209
1-210	3/4	1	1/8	.734 ± .010	.139	1.012	AS568-210
1-211	13/16	1 1/16	1/8	.796	.139	1.074	AS568-211
1-212	7/8	1 1/8	1/8	.859	.139	1.137	AS568-212
1-213	15/16	1 3/16	1/8	.921	.139	1.199	AS568-213
1-214	1	1 1/4	1/8	.984	.139	1.262	AS568-214
1-215	1 1/16	1 5/16	1/8	1.046	.139	1.324	AS568-215
1-216	1 1/8	1 3/8	1/8	1.109 ± .012	.139	1.387	AS568-216
1-217	1 3/16	1 7/16	1/8	1.171	.139	1.449	AS568-217

Use Scale below to verify dimensional integrity

Precision Associates, Inc.
740 N. Washington Ave.
Minneapolis, MN 55401
© Copyright 1972, 2006 Precision Associates, Inc.

Phone: (612) 333-7464
Fax: (612) 342-2417
Toll: (800) 394-6590

www.PrecisionAssoc.com



O-Rings Special Size



Precision Associates has one of the industries largest collections of special size O-Ring tools. Currently we have over 2,000 different size O-Rings in production. On average, we add a new size each week. To keep up on all of the new sizes, please check out our website at www.PrecisionAssoc.com.

The O-Rings listed here are in order by Inside Diameter (ID) and then Cross Section (C/S). You may also want to reference our Engineer's Guide. It has all of PAI's O-Rings, including Standard Sizes listed in ascending order by OD, with tolerances and volumetric data. If you still can't find the O-Ring to fit your special need, please call our engineering department. Our In-House Tool Shop can produce a mold in short order at a very reasonable cost.

Mold IDen	C/S	ID	OD (Ref)
12-145	0.012	0.145	0.169
16-47	0.016	0.047	0.079
16-171	0.016	0.171	0.203
16-175	0.016	0.175	0.207
16-438	0.016	0.438	0.470
17-30	0.017	0.030	0.064
17-44	0.017	0.044	0.078
17-65	0.017	0.065	0.099
17-2.400	0.017	2.400	2.434
18-81ES	0.018	0.082	0.118
19-38	0.019	0.038	0.076
20-17	0.020	0.017	0.057
20-30	0.020	0.030	0.070
20-45	0.020	0.045	0.085
20-87	0.020	0.087	0.127
20-90	0.020	0.090	0.130
20-150	0.020	0.150	0.190
20-170	0.020	0.170	0.210
20-170VS	0.020	0.172	0.212
20-248	0.020	0.248	0.288
20-305	0.020	0.305	0.345
20-515	0.020	0.515	0.555
20-583ES	0.020	0.587	0.627
20-595	0.020	0.595	0.635
21-74	0.021	0.074	0.116
21-260	0.021	0.260	0.302
22-63	0.022	0.063	0.107
22-20.370	0.022	20.370	20.414
23-41	0.023	0.041	0.087
23-84	0.023	0.084	0.130
23-98	0.023	0.098	0.144
23-144	0.023	0.145	0.191
23-150ES	0.023	0.151	0.197
23-191	0.023	0.191	0.237
23-200	0.023	0.202	0.248
24-169	0.024	0.169	0.217
24-205	0.024	0.205	0.253

Mold IDen	C/S	ID	OD (Ref)
24-285VS	0.024	0.287	0.333
24-472	0.024	0.472	0.520
24-945	0.024	0.945	0.993
25-10	0.025	0.010	0.060
25-70	0.025	0.070	0.120
25-90	0.025	0.090	0.140
25-130	0.025	0.130	0.180
25-137SS	0.025	0.138	0.188
25-144	0.025	0.144	0.194
25-190SS	0.025	0.196	0.246
25-218	0.025	0.218	0.268
25-237	0.025	0.237	0.287
25-285	0.025	0.285	0.335
25-301	0.025	0.301	0.351
25-507	0.025	0.507	0.557
25-1.110	0.025	1.110	1.160
25-1.115	0.025	1.115	1.165
25-2.000	0.025	2.000	2.050
26-97	0.026	0.097	0.149
25-356SS	0.026	0.366	0.418
26-492VS	0.026	0.497	0.549
26-1.080	0.026	1.080	1.132
27-32	0.027	0.032	0.086
27-143	0.027	0.143	0.197
28-81	0.028	0.081	0.137
28-94	0.028	0.094	0.150
28-110	0.028	0.110	0.166
28-210SS	0.028	0.213	0.269
28-320VS	0.028	0.323	0.379
28-346VS	0.028	0.351	0.407
28-457	0.028	0.457	0.513
28-457VS	0.028	0.463	0.519
28-1.181	0.028	1.181	1.237
29-22	0.029	0.022	0.080
29-76	0.029	0.076	0.134
29-134	0.029	0.134	0.192
30-23	0.030	0.023	0.083



O-Rings

Special Size



Mold IDen	C/S	ID	OD (Ref)
30-70	0.030	0.070	0.130
30-78	0.030	0.078	0.138
30-98	0.030	0.098	0.158
30-103	0.030	0.103	0.163
30-118VS	0.030	0.120	0.180
30-140SS	0.030	0.141	0.201
30-176	0.030	0.176	0.236
30-208	0.030	0.208	0.268
30-212SS	0.030	0.214	0.274
30-239VS	0.030	0.241	0.301
30-272SS	0.030	0.275	0.335
30-368VS	0.030	0.373	0.433
30-468	0.030	0.468	0.528
30-577	0.030	0.577	0.637
30-622	0.030	0.622	0.682
30-622SS	0.030	0.631	0.691
30-690	0.030	0.690	0.750
30-810ES	0.030	0.812	0.872
30-840	0.030	0.840	0.900
30-980SS	0.030	0.994	1.054
30-1.010VS	0.030	1.019	1.079
30-1.190	0.030	1.190	1.250
30-1.272	0.030	1.272	1.332
30-1.377ES	0.030	1.379	1.439
30-1.635	0.030	1.635	1.695
30-2.472SS	0.030	2.482	2.542
30-3.145	0.030	3.145	3.205
30-4.523	0.030	4.507	4.567
31-43	0.031	0.043	0.105
31-43SS	0.031	0.044	0.106
31-125	0.031	0.125	0.187
31-146	0.031	0.146	0.208
31-187	0.031	0.187	0.249
31-238	0.031	0.238	0.300
31-312	0.031	0.312	0.374
31-332	0.031	0.332	0.394
31-410	0.031	0.410	0.472
31-435	0.031	0.435	0.497
31-526	0.031	0.526	0.588
31-643	0.031	0.643	0.705
31-779	0.031	0.779	0.841
31-898	0.031	0.898	0.960
31-915	0.031	0.915	0.977
31-1.071	0.031	1.071	1.133
31-1.226	0.031	1.226	1.288

Mold IDen	C/S	ID	OD (Ref)
31-1.226ES	0.031	1.232	1.294
31-1.331	0.031	1.331	1.393
31-1.491	0.031	1.491	1.553
31-1.718	0.031	1.724	1.786
32-39	0.032	0.039	0.103
32-55	0.032	0.055	0.119
32-62	0.032	0.062	0.126
32-110VS	0.032	0.111	0.175
32-154	0.032	0.154	0.218
32-220	0.032	0.220	0.284
32-250	0.032	0.250	0.314
32-409SS	0.032	0.413	0.477
32-551SS	0.032	0.556	0.620
32-551VS	0.032	0.557	0.621
32-860	0.032	0.860	0.924
32-995	0.032	0.995	1.059
32-1.039	0.032	1.039	1.103
32-1.050	0.032	1.050	1.114
32-1.100	0.032	1.100	1.164
32-1.790	0.032	1.790	1.854
32-2.500SS	0.032	2.524	2.588
32-295VS	0.032	0.297	0.362
33-210	0.033	0.210	0.276
34-46	0.034	0.046	0.114
34-70	0.034	0.070	0.138
33-78SS	0.034	0.080	0.148
34-86	0.034	0.086	0.154
34-106	0.034	0.106	0.174
33-210SS	0.034	0.214	0.282
34-232SS	0.034	0.235	0.303
34-256	0.034	0.256	0.324
34-306	0.034	0.306	0.374
34-432	0.034	0.432	0.500
34-611ES	0.034	0.617	0.685
35-18	0.035	0.018	0.088
35-50	0.035	0.050	0.120
35-65	0.035	0.065	0.135
35-75	0.035	0.075	0.145
35-100SS	0.035	0.101	0.171
34-118SS	0.035	0.120	0.190
35-130	0.035	0.130	0.200
35-188VS	0.035	0.190	0.260
35-190	0.035	0.190	0.260
35-250	0.035	0.250	0.320
35-283SS	0.035	0.286	0.356

Precision Associates, Inc.

740 N. Washington Ave.
Minneapolis, MN 55401

16

Phone: 612-333-7464

Fax: 612-342-2417

Toll: 800-394-6590

www.PrecisionAssoc.com



O-Rings Special Size



Mold IDen	C/S	ID	OD (Ref)
35-322	0.035	0.322	0.392
35-361	0.035	0.361	0.431
35-362	0.035	0.361	0.431
35-950SS	0.035	0.959	1.029
35-964ES	0.035	0.967	1.037
36-47	0.036	0.047	0.119
36-89	0.036	0.089	0.161
36-138	0.036	0.138	0.210
36-152	0.036	0.152	0.224
36-312SS	0.036	0.315	0.387
35-318VS	0.036	0.323	0.395
36-465	0.036	0.465	0.537
36-732	0.036	0.730	0.802
36-1.118	0.036	1.120	1.192
37-172	0.037	0.172	0.246
37-220	0.037	0.220	0.294
36-272SS	0.037	0.277	0.351
37-1.080	0.037	1.082	1.156
36-2.050SS	0.037	2.089	2.163
38-14	0.038	0.014	0.090
38-100	0.038	0.100	0.176
38-157	0.038	0.157	0.233
38-301	0.038	0.301	0.377
38-377	0.038	0.377	0.453
38-1.984	0.038	1.984	2.060
38-1.980ES	0.038	1.985	2.061
39-189SS	0.039	0.191	0.269
39-208	0.039	0.208	0.286
39-295	0.039	0.295	0.373
39-327	0.039	0.327	0.405
39-386	0.039	0.386	0.464
39-408	0.039	0.408	0.486
39-433	0.039	0.433	0.511
39-492	0.039	0.492	0.570
39-535	0.039	0.535	0.613
39-570	0.039	0.570	0.648
39-630	0.039	0.630	0.708
39-1.189	0.039	1.189	1.267
39-1.290	0.039	1.290	1.368
39-1.340	0.039	1.340	1.418
39-1.437	0.039	1.437	1.515
39-1.476	0.039	1.476	1.554
38-1.463SS	0.039	1.485	1.563
39-1.732	0.039	1.732	1.810
39-1.772SS	0.039	1.787	1.865

Mold IDen	C/S	ID	OD (Ref)
39-1.969	0.039	1.969	2.047
39-1.969SS	0.039	1.977	2.055
40-17	0.040	0.017	0.097
40-23	0.040	0.023	0.103
40-57	0.040	0.057	0.137
40-59SS	0.040	0.060	0.140
40-87	0.040	0.087	0.167
40-109	0.040	0.109	0.189
40-117	0.040	0.117	0.197
40-126SS	0.040	0.127	0.207
40-136	0.040	0.136	0.216
40-147	0.040	0.147	0.227
40-176	0.040	0.176	0.256
40-180	0.040	0.180	0.260
40-184SS	0.040	0.186	0.266
40-200	0.040	0.200	0.280
40-210	0.040	0.210	0.290
40-228	0.040	0.228	0.308
40-238	0.040	0.238	0.318
40-239	0.040	0.239	0.319
40-258	0.040	0.258	0.338
40-370	0.040	0.370	0.450
40-395	0.040	0.395	0.475
40-426	0.040	0.426	0.506
40-440	0.040	0.440	0.520
40-445SS	0.040	0.449	0.529
40-459	0.040	0.459	0.539
40-484	0.040	0.484	0.564
40-508NS	0.040	0.506	0.586
40-550	0.040	0.550	0.630
39-550VS	0.040	0.557	0.637
40-612	0.040	0.612	0.692
40-660	0.040	0.660	0.740
40-701	0.040	0.701	0.781
40-725	0.040	0.725	0.805
40-750	0.040	0.750	0.830
40-785	0.040	0.785	0.865
40-820	0.040	0.820	0.900
40-825	0.040	0.825	0.905
40-879	0.040	0.879	0.959
40-929	0.040	0.929	1.009
40-930	0.040	0.930	1.010
40-950	0.040	0.950	1.030
40-1.040	0.040	1.040	1.120
40-1.062	0.040	1.062	1.142

Precision Associates, Inc.
740 N. Washington Ave.
Minneapolis, MN 55401

Phone: 612-333-7464
Fax: 612-342-2417
Toll: 800-394-6590

www.PrecisionAssoc.com



O-Rings Special Size



Mold IDen	C/S	ID	OD (Ref)
40-1.086	0.040	1.086	1.166
40-1.105	0.040	1.105	1.185
40-1.116VS	0.040	1.126	1.206
40-1.220	0.040	1.220	1.300
40-1.249VS	0.040	1.261	1.341
40-1.310	0.040	1.310	1.390
40-1.828	0.040	1.828	1.908
40-1.856	0.040	1.856	1.936
40-1.860	0.040	1.860	1.940
40-1.958	0.040	1.958	2.038
40-2.152	0.040	2.152	2.232
40-2.177	0.040	2.177	2.257
40-2.249	0.040	2.249	2.329
40-2.342	0.040	2.342	2.422
40-2.400	0.040	2.400	2.480
40-2.550	0.040	2.550	2.630
40-2.875	0.040	2.875	2.955
40-3.000	0.040	3.000	3.080
40-3.200SS	0.040	3.230	3.310
40-3.370VS	0.040	3.402	3.482
40-4.140VS	0.040	4.179	4.259
40-583VS	0.040	0.587	0.668
41-216	0.041	0.216	0.298
40-228SS	0.041	0.232	0.314
40-248SS	0.041	0.253	0.335
40-275SS	0.041	0.279	0.361
41-490	0.041	0.490	0.572
40-1.310SS	0.041	1.335	1.417
40-1.350SS	0.041	1.371	1.453
40-2.044SS	0.041	2.087	2.169
42-42	0.042	0.042	0.126
42-55	0.042	0.055	0.139
42-117	0.042	0.118	0.202
42-239	0.042	0.239	0.323
42-301	0.042	0.301	0.385
42-335	0.042	0.335	0.419
42-2.199	0.042	2.199	2.283
42-82	0.043	0.082	0.168
43-45VS	0.043	0.045	0.131
43-150	0.043	0.150	0.236
43-315	0.043	0.315	0.401
43-495TS	0.043	0.497	0.583
43-642SS	0.043	0.646	0.732
43-1.101	0.043	1.101	1.187
43-1.101SS	0.043	1.110	1.196

Mold IDen	C/S	ID	OD (Ref)
43-1.934	0.043	1.934	2.020
44-65	0.044	0.065	0.153
44-97	0.044	0.097	0.185
44-277	0.044	0.277	0.365
44-278	0.044	0.277	0.365
44-4.390	0.044	4.390	4.478
45-35	0.045	0.035	0.125
45-105	0.045	0.105	0.195
45-245	0.045	0.245	0.335
45-290	0.045	0.290	0.380
45-346	0.045	0.346	0.436
45-364	0.045	0.364	0.454
45-405	0.045	0.405	0.495
45-426	0.045	0.426	0.516
45-787VS	0.045	0.794	0.884
45-850	0.045	0.850	0.940
45-990	0.045	0.990	1.080
45-1.153	0.045	1.153	1.243
45-1.340	0.045	1.340	1.430
45-1.395	0.045	1.395	1.485
45-1.510	0.045	1.510	1.600
45-1.540	0.045	1.540	1.630
45-1.600	0.045	1.600	1.690
45-1.650	0.045	1.650	1.740
44-3.038SS	0.045	3.122	3.212
45-6.690	0.045	6.667	6.757
46-152	0.046	0.152	0.244
45-165SS	0.046	0.170	0.262
46-224	0.046	0.224	0.316
46-257	0.046	0.257	0.349
46-307	0.046	0.307	0.399
46-375	0.046	0.375	0.467
46-450	0.046	0.450	0.542
46-656	0.046	0.656	0.748
46-691	0.046	0.691	0.783
46-705	0.046	0.705	0.797
46-967VS	0.046	0.976	1.068
46-1.000SS	0.046	1.007	1.099
46-1.800	0.046	1.807	1.899
46-3.455	0.046	3.455	3.547
47-62	0.047	0.062	0.156
47-87	0.047	0.087	0.181
47-114	0.047	0.114	0.208
46-278VS	0.047	0.283	0.377
46-1.130SS	0.047	1.149	1.243

Precision Associates, Inc.

740 N. Washington Ave.
Minneapolis, MN 55401

18

Phone: 612-333-7464

Fax: 612-342-2417

Toll: 800-394-6590

www.PrecisionAssoc.com



O-Rings Special Size



Mold IDen	C/S	ID	OD (Ref)
47-1.245SS	0.047	1.257	1.351
47-1.453	0.047	1.453	1.547
47-1.575	0.047	1.575	1.669
47-1.672	0.047	1.672	1.766
47-1.891	0.047	1.891	1.985
47-1.934	0.047	1.934	2.028
47-1.954	0.047	1.961	2.055
47-1.954SS	0.047	1.961	2.055
47-2.115SS	0.047	2.124	2.218
47-2.141	0.047	2.141	2.235
47-2.350	0.047	2.350	2.444
47-2.641	0.047	2.641	2.735
47-4.343	0.047	4.343	4.437
47-6.812	0.047	6.812	6.906
48-28	0.048	0.028	0.124
48-84	0.048	0.084	0.180
48-140	0.048	0.140	0.236
48-170	0.048	0.170	0.266
48-185	0.048	0.185	0.281
48-239	0.048	0.239	0.335
48-248	0.048	0.248	0.344
47-490SS	0.048	0.496	0.592
48-1.375	0.048	1.375	1.471
47-1.484SS	0.048	1.501	1.597
47-2.495SS	0.048	2.524	2.620
48-2.666	0.048	2.666	2.762
47-3.053SS	0.048	3.112	3.208
49-508	0.049	0.508	0.606
49-1.130	0.049	1.130	1.228
50-94	0.050	0.094	0.194
50-120	0.050	0.120	0.220
50-129	0.050	0.129	0.229
50-140	0.050	0.140	0.240
50-154	0.050	0.154	0.254
50-176	0.050	0.176	0.276
50-187	0.050	0.187	0.287
50-208	0.050	0.208	0.308
50-287	0.050	0.287	0.387
50-300	0.050	0.300	0.400
50-330	0.050	0.330	0.430
50-366SS	0.050	0.369	0.469
50-397SS	0.050	0.401	0.501
50-426	0.050	0.426	0.526
50-468	0.050	0.468	0.568
50-475SS	0.050	0.480	0.580

Mold IDen	C/S	ID	OD (Ref)
50-590	0.050	0.590	0.690
50-625	0.050	0.625	0.725
50-720	0.050	0.720	0.820
49-782SS	0.050	0.797	0.897
50-875	0.050	0.875	0.975
50-984	0.050	0.984	1.084
50-1.250	0.050	1.250	1.350
50-1.325	0.050	1.325	1.425
50-1.406	0.050	1.411	1.511
50-1.500	0.050	1.500	1.600
50-1.675	0.050	1.675	1.775
50-1.690	0.050	1.690	1.790
50-1.796	0.050	1.796	1.896
50-1.864	0.050	1.864	1.964
50-2.070	0.050	2.070	2.170
50-2.520VS	0.050	2.534	2.634
50-2.719	0.050	2.719	2.819
50-3.670	0.050	3.661	3.761
50-3.670SS	0.050	3.704	3.804
50-5.163VS	0.050	5.212	5.312
50-6.567VS	0.050	6.629	6.729
50-94VS	0.051	0.096	0.198
51-102	0.051	0.102	0.204
51-110	0.051	0.110	0.212
51-239	0.051	0.239	0.341
51-249	0.051	0.249	0.351
51-313	0.051	0.313	0.415
50-386SS	0.051	0.390	0.492
51-547	0.051	0.547	0.649
50-720SS	0.051	0.730	0.832
50-1.750SS	0.051	1.775	1.877
50-5.302VS	0.051	5.365	5.467
52-229	0.052	0.229	0.333
52-306	0.052	0.306	0.410
52-364SS	0.052	0.367	0.471
52-447	0.052	0.447	0.551
51-531ES	0.052	0.537	0.641
51-547VS	0.052	0.557	0.661
52-864	0.052	0.864	0.968
52-910	0.052	0.910	1.014
52-1.245	0.052	1.245	1.349
53-74	0.053	0.074	0.180
53-216	0.053	0.216	0.322
53-270	0.053	0.270	0.376
53-429SS	0.053	0.433	0.539

Precision Associates, Inc.
740 N. Washington Ave.
Minneapolis, MN 55401

Phone: 612-333-7464
Fax: 612-342-2417
Toll: 800-394-6590

www.PrecisionAssoc.com



O-Rings

Special Size



Mold IDen	C/S	ID	OD (Ref)
53-458	0.053	0.458	0.564
52-1.176SS	0.053	1.194	1.300
53-1.257	0.053	1.257	1.363
53-2.394	0.053	2.394	2.500
54-158	0.054	0.158	0.266
54-394	0.054	0.394	0.502
54-1.153	0.054	1.153	1.261
55-85	0.055	0.085	0.195
55-195	0.055	0.195	0.305
54-301VS	0.055	0.304	0.414
54-344SS	0.055	0.351	0.461
55-489	0.055	0.489	0.599
55-530	0.055	0.530	0.640
54-908SS	0.055	0.917	1.027
55-1.000	0.055	1.000	1.110
54-1.228SS	0.055	1.240	1.350
55-1.290	0.055	1.290	1.400
55-1.500	0.055	1.500	1.610
55-1.560	0.055	1.560	1.670
55-1.775	0.055	1.775	1.885
56-60	0.056	0.060	0.172
56-61VS	0.056	0.062	0.174
56-78	0.056	0.078	0.190
56-176	0.056	0.176	0.288
56-1.148	0.056	1.148	1.260
56-125VS	0.057	0.127	0.241
56-239VS	0.057	0.243	0.357
56-355VS	0.057	0.358	0.472
56-414SS	0.057	0.418	0.532
57-658	0.057	0.658	0.772
56-670SS	0.057	0.676	0.790
56-1.506SS	0.057	1.520	1.634
58-610	0.058	0.610	0.726
57-690VS	0.058	0.700	0.816
58-989	0.058	0.989	1.105
58-3.645	0.058	3.645	3.761
58-133SS	0.059	0.136	0.254
59-138	0.059	0.138	0.256
59-158	0.059	0.158	0.276
59-279	0.059	0.279	0.397
59-295	0.059	0.295	0.413
59-416ES	0.059	0.417	0.535
59-472	0.059	0.472	0.590
59-669	0.059	0.669	0.787
59-836SS	0.059	0.841	0.959

Mold IDen	C/S	ID	OD (Ref)
59-866	0.059	0.866	0.984
59-905	0.059	0.905	1.023
59-1.012	0.059	1.012	1.130
59-1.623	0.059	1.623	1.741
59-1.732	0.059	1.732	1.850
59-2.126	0.059	2.126	2.244
59-2.835ES	0.059	2.839	2.957
59-79VS	0.060	0.081	0.201
60-100	0.060	0.100	0.220
60-111	0.060	0.111	0.231
60-134	0.060	0.134	0.254
60-166	0.060	0.166	0.286
59-200VS	0.060	0.203	0.323
60-215	0.060	0.215	0.335
60-246	0.060	0.246	0.366
60-265	0.060	0.265	0.385
60-301	0.060	0.301	0.421
60-340	0.060	0.340	0.460
59-354SS	0.060	0.360	0.480
59-453VS	0.060	0.457	0.577
60-460	0.060	0.460	0.580
60-507	0.060	0.507	0.627
60-575	0.060	0.575	0.695
59-945SS	0.060	0.954	1.074
60-1.051	0.060	1.051	1.171
60-1.173	0.060	1.173	1.293
60-1.214NS	0.060	1.205	1.325
60-1.190SS	0.060	1.214	1.334
60-1.274	0.060	1.274	1.394
60-1.304	0.060	1.304	1.424
60-1.415	0.060	1.415	1.535
60-1.993ES	0.060	1.998	2.118
60-2.287	0.060	2.287	2.407
60-3.156	0.060	3.156	3.276
60-4.500SS	0.060	4.467	4.587
60-6.187	0.060	6.187	6.307
60-7.000	0.060	7.000	7.120
60-217ES	0.061	0.219	0.341
60-364SS	0.061	0.370	0.492
60-1.993SS	0.061	2.021	2.143
60-3.115SS	0.061	3.175	3.297
62-50	0.062	0.050	0.174
62-125	0.062	0.125	0.249
62-188	0.062	0.188	0.312
62-375	0.062	0.375	0.499

Precision Associates, Inc.

740 N. Washington Ave.
Minneapolis, MN 55401

20

Phone: 612-333-7464

Fax: 612-342-2417

Toll: 800-394-6590

www.PrecisionAssoc.com



O-Rings Special Size



Mold IDen	C/S	ID	OD (Ref)
62-400	0.062	0.400	0.524
62-638	0.062	0.638	0.762
62-750	0.062	0.750	0.874
62-1.069	0.062	1.069	1.193
62-1.176	0.062	1.176	1.300
62-1.485	0.062	1.485	1.609
62-1.686	0.062	1.686	1.810
62-1.740	0.062	1.740	1.864
62-1.772	0.062	1.772	1.896
62-2.187	0.062	2.187	2.311
62-5.250	0.062	5.250	5.374
63-94	0.063	0.094	0.220
62-230SS	0.063	0.232	0.358
62-358SS	0.063	0.365	0.491
62-501SS	0.063	0.508	0.634
63-813	0.063	0.813	0.939
63-962	0.063	0.962	1.088
63-1.063	0.063	1.063	1.189
63-1.969	0.063	1.969	2.095
63-2.766	0.063	2.766	2.892
64-53	0.064	0.053	0.181
63-122VS	0.064	0.124	0.252
63-319VS	0.064	0.322	0.450
63-594SS	0.064	0.605	0.733
64-660	0.064	0.660	0.788
63-670SS	0.064	0.676	0.804
63-799VS	0.064	0.807	0.935
63-970ES	0.064	0.979	1.107
63-1.394SS	0.064	1.408	1.536
63-1.472ES	0.064	1.486	1.614
63-6.400VS	0.064	6.460	6.588
65-1.030	0.065	1.030	1.160
65-3.239	0.065	3.239	3.369
65-60SS	0.066	0.061	0.193
65-1.140SS	0.066	1.159	1.291
66-61VS	0.067	0.062	0.196
68-113VS	0.068	0.114	0.250
68-176	0.068	0.176	0.312
68-246	0.068	0.246	0.382
68-598	0.068	0.598	0.734
67-1.541SS	0.068	1.574	1.710
68-364SS	0.069	0.367	0.505
68-438SS	0.069	0.444	0.582
68-843SS	0.069	0.856	0.994
70-108	0.070	0.108	0.248

Mold IDen	C/S	ID	OD (Ref)
70-113ES	0.070	0.113	0.253
70-125	0.070	0.125	0.265
70-161ES	0.070	0.162	0.302
70-187	0.070	0.187	0.327
70-195	0.070	0.195	0.335
70-202	0.070	0.202	0.342
70-219	0.070	0.219	0.359
70-270	0.070	0.270	0.410
70-275	0.070	0.275	0.415
70-291	0.070	0.291	0.431
70-313ES	0.070	0.315	0.455
70-320	0.070	0.320	0.460
70-334	0.070	0.334	0.474
70-373ES	0.070	0.374	0.514
70-395	0.070	0.395	0.535
70-437	0.070	0.437	0.577
70-455	0.070	0.455	0.595
70-460	0.070	0.460	0.600
70-466	0.070	0.466	0.606
70-487VS	0.070	0.490	0.630
70-505	0.070	0.505	0.645
70-583	0.070	0.583	0.723
70-646	0.070	0.646	0.786
70-652	0.070	0.652	0.792
70-706	0.070	0.706	0.846
70-720	0.070	0.720	0.860
70-724	0.070	0.724	0.864
70-769	0.070	0.769	0.909
70-943	0.070	0.943	1.083
70-1.015ES	0.070	1.017	1.157
69-1.157VS	0.070	1.168	1.308
70-1.220ES	0.070	1.222	1.362
70-1.424	0.070	1.424	1.564
70-1.427	0.070	1.427	1.567
70-1.465	0.070	1.465	1.605
70-1.545	0.070	1.545	1.685
70-1.662	0.070	1.662	1.802
70-1.670	0.070	1.670	1.810
70-1.687	0.070	1.687	1.827
70-1.775	0.070	1.775	1.915
70-1.799	0.070	1.799	1.939
70-1.830	0.070	1.830	1.970
70-1.927	0.070	1.927	2.067
70-2.030	0.070	2.030	2.170
70-2.050	0.070	2.050	2.190

Precision Associates, Inc.
740 N. Washington Ave.
Minneapolis, MN 55401

Phone: 612-333-7464
Fax: 612-342-2417
Toll: 800-394-6590

www.PrecisionAssoc.com



O-Rings Special Size



Mold IDen	C/S	ID	OD (Ref)
70-2.093SS	0.070	2.102	2.242
70-2.156	0.070	2.156	2.296
70-2.175	0.070	2.175	2.315
70-2.250	0.070	2.250	2.390
70-2.307	0.070	2.307	2.447
70-2.425	0.070	2.425	2.565
70-2.560	0.070	2.560	2.700
70-2.677	0.070	2.677	2.817
70-2.750ES	0.070	2.754	2.894
70-2.800	0.070	2.800	2.940
70-2.921	0.070	2.921	3.061
70-2.950ES	0.070	2.954	3.094
70-3.085	0.070	3.085	3.225
70-3.440	0.070	3.440	3.580
70-3.474	0.070	3.474	3.614
70-3.562	0.070	3.562	3.702
70-3.860	0.070	3.860	4.000
70-3.937	0.070	3.937	4.077
70-4.300	0.070	4.300	4.440
70-4.562	0.070	4.562	4.702
70-4.672	0.070	4.672	4.812
70-4.864	0.070	4.864	5.004
70-4.890	0.070	4.890	5.030
70-5.114	0.070	5.114	5.254
70-5.360	0.070	5.360	5.500
70-5.379	0.070	5.379	5.519
70-5.700	0.070	5.703	5.843
70-5.968	0.070	5.968	6.108
70-6.180	0.070	6.180	6.320
70-6.284ES	0.070	6.306	6.446
70-6.309	0.070	6.309	6.449
70-6.310VS	0.070	6.349	6.489
70-6.520	0.070	6.520	6.660
70-6.687	0.070	6.687	6.827
70-6.734	0.070	6.734	6.874
70-6.950	0.070	6.950	7.090
70-7.360ES	0.070	7.371	7.511
70-7.500	0.070	7.500	7.640
70-7.613	0.070	7.613	7.753
70-7.870	0.070	7.870	8.010
70-8.135ES	0.070	8.148	8.288
70-9.435ES	0.070	9.450	9.590
70-9.650ES	0.070	9.665	9.805
70-9.970	0.070	9.970	10.110
70-10.433ES	0.070	10.459	10.599

Mold IDen	C/S	ID	OD (Ref)
70-10.485	0.070	10.485	10.625
70-10.800ES	0.070	10.817	10.957
70-11.085ES	0.070	11.102	11.242
70-11.339ES	0.070	11.368	11.508
70-11.989	0.070	11.989	12.129
70-12.720	0.070	12.720	12.860
70-13.114ES	0.070	13.134	13.274
70-16.268SS	0.070	16.357	16.497
70-16.535	0.070	16.577	16.717
70-87	0.071	0.088	0.230
70-98SS	0.071	0.099	0.241
70-127SS	0.071	0.129	0.271
71-211ES	0.071	0.212	0.354
71-248	0.071	0.248	0.390
70-258SS	0.071	0.262	0.404
70-270SS	0.071	0.275	0.417
70-285SS	0.071	0.290	0.432
70-313VS	0.071	0.317	0.459
70-344SS	0.071	0.349	0.491
70-418SS	0.071	0.425	0.567
70-468SS	0.071	0.472	0.614
70-478VS	0.071	0.482	0.624
70-495SS	0.071	0.503	0.645
70-575SS	0.071	0.585	0.727
70-590VS	0.071	0.596	0.738
70-646SS	0.071	0.658	0.800
71-810	0.071	0.810	0.952
70-850VS	0.071	0.858	1.000
70-879SS	0.071	0.896	1.038
70-985SS	0.071	0.992	1.134
70-1.082SS	0.071	1.100	1.242
70-1.114SS	0.071	1.130	1.272
70-1.378VS	0.071	1.397	1.539
70-1.437SS	0.071	1.454	1.596
70-1.614SS	0.071	1.634	1.776
70-1.738VS	0.071	1.761	1.903
70-1.864SS	0.071	1.900	2.042
70-2.410SS	0.071	2.447	2.589
70-2.690VS	0.071	2.715	2.857
70-2.739SS	0.071	2.792	2.934
70-3.114VS	0.071	3.146	3.288
70-6.722SS	0.071	6.785	6.927
70-9.989VS	0.071	10.112	10.254
70-10.232SS	0.071	10.328	10.470
70-10.530SS	0.071	10.629	10.771

Precision Associates, Inc.

740 N. Washington Ave.
Minneapolis, MN 55401

22

Phone: 612-333-7464

Fax: 612-342-2417

Toll: 800-394-6590

www.PrecisionAssoc.com



O-Rings Special Size



Mold IDen	C/S	ID	OD (Ref)
71-10.635	0.071	10.635	10.777
70-11.240SS	0.071	11.423	11.565
70-20.840SS	0.071	21.077	21.219
70-21.270SS	0.071	21.512	21.654
70-25.570SS	0.071	25.810	25.952
72-97VS	0.072	0.098	0.242
71-256VS	0.072	0.259	0.403
70-518SS	0.072	0.529	0.673
71-525SS	0.072	0.533	0.677
70-688SS	0.072	0.703	0.847
70-739SS	0.072	0.760	0.904
70-831SS	0.072	0.850	0.994
70-843SSS	0.072	0.866	1.010
72-926	0.072	0.926	1.070
71-1.046SS	0.072	1.065	1.209
70-1.240SS	0.072	1.267	1.411
71-1.280VS	0.072	1.293	1.437
71-2.638VS	0.072	2.666	2.810
71-4.409VS	0.072	4.455	4.599
73-40	0.073	0.040	0.186
70-145SS	0.073	0.152	0.298
73-182	0.073	0.182	0.328
73-357	0.073	0.357	0.503
70-489SS	0.073	0.508	0.654
73-735	0.073	0.735	0.881
73-1.639	0.073	1.639	1.785
74-224	0.074	0.224	0.372
73-239SS	0.074	0.241	0.389
74-317	0.074	0.317	0.465
74-350	0.074	0.350	0.498
74-614	0.074	0.614	0.762
74-6.100	0.074	6.080	6.228
75-85	0.075	0.085	0.235
75-134	0.075	0.134	0.284
75-165	0.075	0.165	0.315
74-362VS	0.075	0.367	0.517
74-375VS	0.075	0.379	0.529
74-401VS	0.075	0.405	0.555
75-710	0.075	0.710	0.860
75-1.414	0.075	1.414	1.564
75-1.840	0.075	1.840	1.990
75-2.066	0.075	2.066	2.216
75-3.600	0.075	3.600	3.750
76-60	0.076	0.060	0.212
76-145	0.076	0.145	0.297

Mold IDen	C/S	ID	OD (Ref)
75-262SS	0.076	0.266	0.418
75-268SS	0.076	0.271	0.423
76-277	0.076	0.277	0.429
76-382	0.076	0.382	0.534
76-432	0.076	0.432	0.584
75-489SS	0.076	0.498	0.650
76-1.188	0.076	1.188	1.340
76-1.580	0.076	1.580	1.732
77-240	0.077	0.240	0.394
77-614	0.077	0.614	0.768
78-236	0.078	0.236	0.392
77-250SS	0.078	0.255	0.411
78-312	0.078	0.312	0.468
78-1.102	0.078	1.102	1.258
78-1.234	0.078	1.234	1.390
77-1.362VS	0.078	1.387	1.543
78-1.417	0.078	1.417	1.573
78-1.609	0.078	1.609	1.765
78-2.919	0.078	2.919	3.075
79-224	0.079	0.224	0.382
77-468SS	0.079	0.478	0.636
79-551	0.079	0.551	0.709
79-591NS	0.079	0.589	0.747
79-866ES	0.079	0.870	1.028
79-945	0.079	0.945	1.103
79-1.063	0.079	1.063	1.221
79-1.772	0.079	1.772	1.930
79-1.850	0.079	1.850	2.008
79-2.135ES	0.079	2.140	2.298
79-2.943ES	0.079	2.950	3.108
78-4.266SS	0.079	4.348	4.506
80-54	0.080	0.054	0.214
80-120	0.080	0.120	0.280
80-145	0.080	0.145	0.305
80-250	0.080	0.250	0.410
80-364	0.080	0.364	0.524
79-370SS	0.080	0.375	0.535
80-400	0.080	0.400	0.560
80-406	0.080	0.406	0.566
79-623SS	0.080	0.634	0.794
79-630SS	0.080	0.637	0.797
79-669VS	0.080	0.673	0.833
80-796	0.080	0.796	0.956
80-1.000SS	0.080	1.010	1.170
80-1.370	0.080	1.370	1.530

Precision Associates, Inc.
740 N. Washington Ave.
Minneapolis, MN 55401

Phone: 612-333-7464
Fax: 612-342-2417
Toll: 800-394-6590

www.PrecisionAssoc.com



O-Rings

Special Size



Mold IDen	C/S	ID	OD (Ref)
79-1.457ES	0.080	1.466	1.626
80-1.921	0.080	1.921	2.081
80-2.000	0.080	2.000	2.160
79-2.283ES	0.080	2.304	2.464
79-2.480SS	0.080	2.508	2.668
80-2.585	0.080	2.585	2.745
79-3.218VS	0.080	3.257	3.417
80-3.375	0.080	3.375	3.535
80-3.500	0.080	3.500	3.660
79-5.315VS	0.080	5.396	5.556
80-6.250	0.080	6.250	6.410
80-6.500	0.080	6.500	6.660
81-87	0.081	0.087	0.249
80-208VS	0.081	0.210	0.372
79-335SS	0.081	0.341	0.503
79-354SS	0.081	0.361	0.523
80-364VS	0.081	0.369	0.531
79-450SS	0.081	0.459	0.621
80-758SS	0.081	0.769	0.931
80-850SS	0.081	0.860	1.022
81-925	0.081	0.925	1.087
81-1.114	0.081	1.114	1.276
81-1.489	0.081	1.489	1.651
80-3.483VS	0.081	3.509	3.671
80-443SS	0.082	0.452	0.616
80-551SS	0.082	0.562	0.726
82-750	0.082	0.750	0.914
83-606	0.083	0.606	0.772
83-906	0.083	0.906	1.072
83-2.226	0.083	2.226	2.392
83-3.083	0.083	3.087	3.253
83-4.226	0.083	4.226	4.392
84-446	0.084	0.446	0.614
84-456	0.084	0.456	0.624
84-3.506	0.084	3.506	3.674
85-80	0.085	0.080	0.250
83-676SS	0.085	0.690	0.860
84-2.661SS	0.085	2.702	2.872
85-2.875	0.085	2.875	3.045
86-37	0.086	0.037	0.209
86-290	0.086	0.290	0.462
86-336	0.086	0.336	0.508
86-675	0.086	0.675	0.847
87-644	0.087	0.644	0.818
87-705	0.087	0.705	0.879

Mold IDen	C/S	ID	OD (Ref)
87-817	0.087	0.817	0.991
87-3.307	0.087	3.307	3.481
88-135	0.088	0.135	0.311
87-14.470SS	0.088	14.649	14.825
87-158SS	0.089	0.161	0.339
89-255SS	0.090	0.259	0.439
88-910SS	0.090	0.931	1.111
90-1.091SS	0.090	1.087	1.267
90-2.832	0.090	2.832	3.012
90-3.661	0.090	3.661	3.841
90-208VS	0.091	0.210	0.392
90-324VS	0.091	0.328	0.510
91-380	0.091	0.380	0.562
91-702	0.091	0.702	0.884
92-400	0.092	0.400	0.584
90-401SS	0.092	0.409	0.593
92-590	0.092	0.590	0.774
90-854SS	0.092	0.872	1.056
92-1.259	0.092	1.259	1.443
92-1.338	0.092	1.338	1.522
90-1.387SS	0.092	1.411	1.595
92-1.550	0.092	1.550	1.734
93-085	0.093	0.085	0.271
93-166	0.093	0.166	0.352
93-250	0.093	0.250	0.436
93-375	0.093	0.375	0.561
93-437ES	0.093	0.438	0.624
93-500	0.093	0.500	0.686
92-635SS	0.093	0.644	0.830
91-760SS	0.093	0.773	0.959
93-1.040	0.093	1.040	1.226
93-1.065	0.093	1.065	1.251
93-1.415	0.093	1.415	1.601
93-1.689NS	0.093	1.685	1.871
93-1.689SS	0.093	1.685	1.871
93-1.750	0.093	1.744	1.930
93-1.888	0.093	1.888	2.074
93-2.065VS	0.093	2.070	2.256
93-2.277	0.093	2.277	2.463
91-6.394SS	0.093	6.510	6.696
93-11.500	0.093	11.541	11.727
93-10ES	0.094	0.010	0.198
94-57	0.094	0.057	0.245
94-656	0.094	0.066	0.844
94-142	0.094	0.142	0.330

Precision Associates, Inc.

740 N. Washington Ave.
Minneapolis, MN 55401

24

Phone: 612-333-7464

Fax: 612-342-2417

Toll: 800-394-6590

www.PrecisionAssoc.com



O-Rings

Special Size



Mold IDen	C/S	ID	OD (Ref)
94-523	0.094	0.523	0.711
92-590SS	0.094	0.601	0.789
94-1.188	0.094	1.188	1.376
93-1.320SS	0.094	1.330	1.518
94-1.437	0.094	1.437	1.625
93-1.888ES	0.094	1.910	2.098
94-6.500	0.094	6.500	6.688
93-15ES	0.095	0.015	0.205
95-130	0.095	0.130	0.320
94-248VS	0.095	0.251	0.441
94-287VS	0.095	0.291	0.481
94-366SS	0.095	0.369	0.559
95-418	0.095	0.418	0.608
94-445VS	0.095	0.451	0.641
95-618	0.095	0.618	0.808
93-634SS	0.095	0.648	0.838
95-3.744	0.095	3.744	3.934
94-614SS	0.096	0.624	0.816
97-312	0.097	0.312	0.506
95-320SS	0.097	0.326	0.520
95-590SS	0.097	0.601	0.795
97-5.723	0.097	5.723	5.917
98-197	0.098	0.197	0.393
98-512	0.098	0.512	0.708
98-591	0.098	0.591	0.787
98-1.063	0.098	1.063	1.259
98-1.772	0.098	1.772	1.968
98-2.283	0.098	2.283	2.479
100-520	0.100	0.520	0.720
98-520SS	0.100	0.530	0.730
100-760	0.100	0.760	0.960
100-984	0.100	0.984	1.184
101-2.015SS	0.102	2.030	2.234
103-312	0.103	0.312	0.518
103-326	0.103	0.326	0.532
103-391	0.103	0.391	0.597
103-456	0.103	0.456	0.662
103-590	0.103	0.590	0.796
103-643	0.103	0.643	0.849
103-700	0.103	0.700	0.906
103-734PL	0.103	0.734	0.940
103-768	0.103	0.768	0.974
103-814	0.103	0.814	1.020
103-850	0.103	0.848	1.054
103-940	0.103	0.940	1.146

Mold IDen	C/S	ID	OD (Ref)
103-1.718	0.103	1.718	1.924
103-1.812	0.103	1.812	2.018
103-1.968	0.103	1.968	2.174
103-2.340	0.103	2.340	2.546
103-2.450	0.103	2.450	2.656
103-2.830	0.103	2.830	3.036
103-3.000	0.103	3.000	3.206
103-3.109	0.103	3.109	3.315
103-3.147	0.103	3.147	3.353
103-3.290	0.103	3.290	3.496
103-3.359	0.103	3.359	3.565
103-3.362	0.103	3.362	3.568
103-3.410ES	0.103	3.415	3.621
103-3.460ES	0.103	3.469	3.675
103-3.612	0.103	3.612	3.818
103-3.837	0.103	3.837	4.043
103-3.875	0.103	3.891	4.097
103-4.093	0.103	4.093	4.299
103-4.109	0.103	4.109	4.315
103-4.169	0.103	4.169	4.375
103-4.175	0.103	4.175	4.381
103-4.204ES	0.103	4.215	4.421
103-4.300ES	0.103	4.311	4.517
103-4.350	0.103	4.350	4.556
103-4.359	0.103	4.359	4.565
103-4.397	0.103	4.397	4.603
103-4.487ES	0.103	4.498	4.704
103-4.612	0.103	4.612	4.818
103-4.859	0.103	4.859	5.065
103-4.886ES	0.103	4.898	5.104
103-4.930	0.103	4.930	5.136
103-5.106	0.103	5.106	5.312
103-5.117	0.103	5.117	5.323
103-5.140ES	0.103	5.153	5.359
103-5.272ES	0.103	5.285	5.491
103-5.300ES	0.103	5.313	5.519
103-5.322ES	0.103	5.336	5.542
103-5.380ES	0.103	5.394	5.600
103-5.483ES	0.103	5.497	5.703
103-5.496ES	0.103	5.510	5.716
103-5.602	0.103	5.602	5.808
103-5.750ES	0.103	5.765	5.971
103-6.097	0.103	6.097	6.303
103-6.125	0.103	6.125	6.331
103-6.167ES	0.103	6.183	6.389

Precision Associates, Inc.
740 N. Washington Ave.
Minneapolis, MN 55401

Phone: 612-333-7464
Fax: 612-342-2417
Toll: 800-394-6590

www.PrecisionAssoc.com



O-Rings Special Size



Mold IDen	C/S	ID	OD (Ref)
103-6.380	0.103	6.380	6.586
103-6.400ES	0.103	6.416	6.622
103-6.424	0.103	6.424	6.630
103-6.501ES	0.103	6.518	6.724
103-6.674ES	0.103	6.691	6.897
103-6.850ES	0.103	6.867	7.073
103-7.300ES	0.103	7.319	7.525
103-7.416	0.103	7.435	7.641
103-7.583ES	0.103	7.602	7.808
103-7.673ES	0.103	7.692	7.898
103-7.862	0.103	7.862	8.068
103-7.848ES	0.103	7.868	8.074
103-7.950NS	0.103	7.939	8.145
103-7.950ES	0.103	7.970	8.176
103-8.282ES	0.103	8.303	8.509
103-8.825ES	0.103	8.847	9.053
103-8.840ES	0.103	8.862	9.068
103-8.998ES	0.103	9.021	9.227
103-9.500ES	0.103	9.524	9.730
103-9.892ES	0.103	9.917	10.123
103-9.940ES	0.103	9.965	10.171
103-9.982ES	0.103	10.007	10.213
103-10.095ES	0.103	10.121	10.327
103-10.450ES	0.103	10.487	10.693
103-10.622ES	0.103	10.649	10.855
103-10.781ES	0.103	10.808	11.014
103-10.984	0.103	10.984	11.190
103-10.964ES	0.103	10.992	11.198
103-11.150ES	0.103	11.178	11.384
103-11.239NS	0.103	11.190	11.396
103-11.897NS	0.103	11.846	12.052
103-12.155ES	0.103	12.186	12.392
103-13.425ES	0.103	13.459	13.665
103-374VS	0.104	0.378	0.586
104-681	0.104	0.681	0.889
104-1.222	0.104	1.222	1.430
104-1.628	0.104	1.628	1.836
103-1.889SS	0.104	1.909	2.117
103-3.185SS	0.104	3.222	3.430
103-4.609SS	0.104	4.654	4.862
104-5.305	0.104	5.305	5.513
104-10.372	0.104	10.372	10.580
103-10.449	0.104	10.517	10.725
103-11.096SS	0.104	11.200	11.408
104-14.990	0.104	14.990	15.198

Mold IDen	C/S	ID	OD (Ref)
104-272VS	0.105	0.275	0.485
104-417VS	0.105	0.421	0.631
105-605	0.105	0.605	0.815
103-612SS	0.105	0.622	0.832
104-787VS	0.105	0.794	1.004
104-835VS	0.105	0.843	1.053
103-1.612SS	0.105	1.637	1.847
105-2.500	0.105	2.500	2.710
103-2.675SS	0.105	2.726	2.936
103-3.862	0.105	3.938	4.148
105-5.566	0.105	5.566	5.776
103-10.500SS	0.105	10.660	10.870
103-10.710SS	0.105	10.958	11.168
106-375	0.106	0.375	0.587
106-480	0.106	0.480	0.692
105-485PL	0.106	0.487	0.699
106-570	0.106	0.570	0.782
106-665VS	0.107	0.674	0.888
108-305	0.108	0.305	0.521
108-1.674	0.108	1.674	1.890
108-2.487	0.108	2.487	2.703
109-70	0.109	0.070	0.288
109-562	0.109	0.562	0.780
108-2.100VS	0.109	2.117	2.335
110-265NS	0.110	0.264	0.484
110-299	0.110	0.299	0.519
110-438	0.110	0.438	0.658
110-487	0.110	0.487	0.707
110-16.186	0.110	16.186	16.406
111-1.424	0.111	1.424	1.646
111-3.422	0.111	3.422	3.644
111-4.322	0.111	4.322	4.544
112-549ES	0.112	0.550	0.774
112-6.378SS	0.112	6.325	6.549
113-477	0.113	0.477	0.703
113-539	0.113	0.539	0.765
113-674	0.113	0.674	0.900
115-2.683	0.115	2.683	2.913
117-4.750	0.117	4.734	4.968
118-352	0.118	0.352	0.588
118-453	0.118	0.453	0.689
118-709	0.118	0.709	0.945
118-953	0.118	0.953	1.189
118-2.342	0.118	2.342	2.578
118-2.913	0.118	2.913	3.149

Precision Associates, Inc.

740 N. Washington Ave.
Minneapolis, MN 55401

26

Phone: 612-333-7464

Fax: 612-342-2417

Toll: 800-394-6590

www.PrecisionAssoc.com



O-Rings Special Size



Mold IDen	C/S	ID	OD (Ref)
118-3.130	0.118	3.130	3.366
118-3.819	0.118	3.819	4.055
118-5.492	0.118	5.492	5.728
118-5.689	0.118	5.689	5.925
118-5.905	0.118	5.905	6.141
119-374	0.119	0.374	0.612
118-728SS	0.119	0.735	0.973
118-748VS	0.119	0.755	0.993
118-787VS	0.119	0.794	1.032
118-1.543VS	0.119	1.563	1.801
118-1.583SS	0.119	1.593	1.831
118-1.595VS	0.119	1.602	1.840
118-1.673VS	0.119	1.689	1.927
119-1.888	0.119	1.888	2.126
118-1.969SS	0.119	1.986	2.224
118-2.175VS	0.119	2.201	2.439
118-2.584ES	0.119	2.596	2.834
118-8.504VS	0.119	8.584	8.822
120-445	0.120	0.445	0.685
118-795SS	0.120	0.810	1.050
120-1.280	0.120	1.280	1.520
118-2.520VS	0.120	2.551	2.791
118-6.378VS	0.120	6.460	6.700
121-029	0.121	0.029	0.271
121-485	0.121	0.485	0.727
121-5.562	0.121	5.562	5.804
122-200	0.122	0.200	0.444
120-636SS	0.122	0.645	0.889
122-3.520	0.122	3.520	3.764
123-924	0.123	0.924	1.170
124-21.000	0.124	21.000	21.248
125-219	0.125	0.219	0.469
125-247	0.125	0.247	0.497
125-327	0.125	0.326	0.576
125-348	0.125	0.348	0.598
125-375	0.125	0.375	0.625
125-500	0.125	0.500	0.750
125-625	0.125	0.625	0.875
125-827	0.125	0.827	1.077
125-900	0.125	0.900	1.150
125-1.515	0.125	1.515	1.765
125-1.575	0.125	1.575	1.825
125-1.688	0.125	1.688	1.938
125-1.812	0.125	1.812	2.062
125-1.950	0.125	1.950	2.200

Mold IDen	C/S	ID	OD (Ref)
125-1.968	0.125	1.967	2.217
125-2.140	0.125	2.140	2.390
125-2.250	0.125	2.250	2.500
125-3.562	0.125	3.562	3.812
125-3.640	0.125	3.640	3.890
125-4.109	0.125	4.109	4.359
125-5.270	0.125	5.270	5.520
125-5.531	0.125	5.531	5.781
125-6.460	0.125	6.460	6.710
125-18.600	0.125	18.600	18.850
125-343SS	0.126	0.352	0.604
125-950SS	0.126	0.960	1.212
125-1.160ES	0.126	1.168	1.420
125-2.750SS	0.126	2.776	3.028
125-2.756SS	0.126	2.782	3.034
125-3.543SS	0.127	3.597	3.851
130-425	0.130	0.425	0.685
130-3.062	0.130	3.062	3.322
132-445	0.132	0.445	0.709
133-70	0.133	0.070	0.336
133-109	0.133	0.109	0.375
135-312	0.135	0.312	0.582
135-859	0.135	0.859	1.129
138-523	0.138	0.523	0.799
138-708	0.138	0.708	0.984
138-1.491ES	0.138	1.493	1.769
139-109	0.139	0.109	0.387
139-152	0.139	0.152	0.430
139-187	0.139	0.187	0.465
139-417	0.139	0.417	0.695
139-576	0.139	0.576	0.854
139-765	0.139	0.765	1.043
139-953	0.139	0.953	1.231
139-1.546	0.139	1.546	1.824
139-1.790	0.139	1.790	2.068
139-2.046	0.139	2.046	2.324
139-2.425	0.139	2.425	2.703
139-2.601	0.139	2.601	2.879
139-2.671	0.139	2.671	2.949
139-3.910	0.139	3.910	4.188
139-4.046	0.139	4.036	4.314
139-6.350	0.139	6.350	6.628
139-6.350	0.139	6.350	6.628
139-6.609	0.139	6.609	6.887
139-6.850ES	0.139	6.867	7.145

Precision Associates, Inc.
740 N. Washington Ave.
Minneapolis, MN 55401

Phone: 612-333-7464
Fax: 612-342-2417
Toll: 800-394-6590

www.PrecisionAssoc.com



O-Rings Special Size



Mold IDen	C/S	ID	OD (Ref)
139-7.950ES	0.139	7.970	8.248
139-9.700	0.139	9.700	9.978
139-10.178	0.139	10.178	10.456
139-10.610	0.139	10.610	10.888
139-10.610	0.139	10.610	10.888
139-10.734	0.139	10.760	11.038
139-12.278	0.139	12.278	12.556
139-12.484	0.139	12.516	12.794
139-13.062	0.139	13.062	13.340
139-13.234	0.139	13.234	13.512
139-13.248	0.139	13.248	13.526
139-13.484	0.139	13.484	13.762
139-14.484	0.139	14.484	14.762
139-15.484	0.139	15.484	15.762
139-16.455	0.139	16.455	16.733
139-17.455	0.139	17.455	17.733
139-17.480	0.139	17.480	17.758
139-18.455	0.139	18.455	18.733
139-18.875	0.139	18.875	19.153
139-19.455	0.139	19.455	19.733
139-20.455	0.139	20.455	20.733
139-21.455	0.139	21.455	21.733
140-281	0.140	0.281	0.561
139-390	0.140	0.394	0.674
139-452	0.140	0.452	0.732
139-515	0.140	0.515	0.795
139-640	0.140	0.646	0.926
140-1.176	0.140	1.176	1.456
139-4.020SS	0.140	4.037	4.317
139-4.910ES	0.140	4.937	5.217
139-13.114	0.140	13.114	13.394
139-21.800SS	0.140	22.014	22.294
141-905	0.141	0.905	1.187
141-1.005	0.141	1.005	1.287
141-1.226	0.141	1.226	1.508
139-1.265SS	0.141	1.283	1.565
141-2.874	0.141	2.874	3.156
141-3.282	0.141	3.282	3.564
141-4.654	0.141	4.654	4.936
139-12.475VS	0.141	12.653	12.935
142-390NS	0.142	0.389	0.673
140-692SS	0.142	0.701	0.985
139-1.954SS	0.142	1.996	2.280
142-5.466	0.142	5.466	5.750
142-12.224	0.142	12.224	12.508

Mold IDen	C/S	ID	OD (Ref)
140-4.125SS	0.143	4.216	4.502
144-2.629	0.144	2.629	2.917
145-1.109VS	0.146	1.119	1.411
147-1.976	0.147	1.976	2.270
147-2.935	0.147	2.935	3.229
147-3.656	0.147	3.656	3.950
147-4.984	0.147	4.984	5.278
148-453	0.148	0.453	0.749
148-1.385	0.148	1.385	1.681
148-2.859	0.148	2.859	3.155
147-4.984SS	0.148	5.031	5.327
146-7.700SS	0.148	7.817	8.113
149-1.136SS	0.149	1.147	1.445
149-1.180	0.149	1.180	1.478
149-1.213	0.149	1.213	1.511
150-310	0.150	0.310	0.610
150-825	0.150	0.825	1.125
150-886	0.150	0.886	1.186
150-2.400	0.150	2.400	2.700
150-3.734	0.150	3.734	4.034
150-3.859	0.150	3.859	4.159
150-4.295	0.150	4.295	4.595
150-145SVS	0.151	0.146	0.448
151-477	0.151	0.477	0.779
150-850VS	0.151	0.856	1.158
151-1.138	0.151	1.138	1.440
152-2.965	0.152	2.965	3.269
150-6.650SS	0.153	6.778	7.084
155-790	0.155	0.790	1.100
155-4.139	0.155	4.139	4.449
156-218	0.156	0.218	0.530
156-359	0.156	0.359	0.671
156-844	0.156	0.844	1.156
157-1.388SS	0.156	1.380	1.692
156-2.000	0.156	2.000	2.312
156-3.500	0.156	3.500	3.812
156-3.984	0.156	3.984	4.296
156-837ES	0.157	0.842	1.156
157-1.102	0.157	1.102	1.416
157-1.220	0.157	1.220	1.534
157-1.575	0.157	1.575	1.889
157-1.968	0.157	1.968	2.282
157-6.299	0.157	6.299	6.613
157-6.830	0.157	6.830	7.144
157-10.827	0.157	10.827	11.141

Precision Associates, Inc.

740 N. Washington Ave.
Minneapolis, MN 55401

28

Phone: 612-333-7464

Fax: 612-342-2417

Toll: 800-394-6590

www.PrecisionAssoc.com



O-Rings

Special Size



Mold IDen	C/S	ID	OD (Ref)
158-605	0.158	0.605	0.921
158-730	0.158	0.730	1.046
156-938SS	0.158	0.953	1.269
157-2.835VS	0.158	2.859	3.175
159-688	0.159	0.688	1.006
157-715VS	0.159	0.722	1.040
158-855SS	0.159	0.858	1.176
156-875SS	0.159	0.889	1.207
156-1.000SS	0.159	1.016	1.334
158-1.105SS	0.159	1.109	1.427
159-4.850	0.159	4.850	5.168
159-9.950	0.159	9.950	10.268
159-10.600	0.159	10.600	10.918
160-155	0.160	0.155	0.475
160-472	0.160	0.472	0.792
157-5.512VS	0.160	5.607	5.927
160-7.006	0.160	7.006	7.326
162-5.500	0.162	5.500	5.824
164-242	0.164	0.242	0.570
165-456	0.165	0.456	0.786
166-612	0.166	0.612	0.944
167-1.105	0.167	1.105	1.439
167-1.693	0.167	1.693	2.027
164-6.299SS	0.167	6.395	6.729
168-524	0.168	0.524	0.860
168-1.460	0.168	1.460	1.796
168-2.328	0.168	2.328	2.664
169-465	0.169	0.465	0.803
167-10.186SS	0.169	10.282	10.620
170-612	0.170	0.612	0.952
170-3.253	0.170	3.253	3.593
168-5.005VS	0.170	5.057	5.397
171-595	0.171	0.595	0.937
172-480	0.172	0.480	0.824
170-5.118SS	0.172	5.191	5.535
173-1.225	0.173	1.225	1.571
174-239	0.174	0.239	0.587
174-406	0.174	0.406	0.754
174-1.020	0.174	1.020	1.368
176-975	0.176	0.975	1.327
176-1.077	0.176	1.077	1.429
176-1.100	0.176	1.100	1.452
176-1.156	0.176	1.156	1.508
176-1.225	0.176	1.225	1.577
176-1.236	0.176	1.236	1.588

Mold IDen	C/S	ID	OD (Ref)
176-1.350	0.176	1.350	1.702
176-1.475	0.176	1.475	1.827
176-1.550	0.176	1.550	1.902
176-1.600	0.176	1.600	1.952
176-1.725	0.176	1.725	2.077
176-1.747	0.176	1.747	2.099
176-1.850	0.176	1.850	2.202
176-1.975	0.176	1.975	2.327
176-2.085	0.176	2.085	2.437
176-2.100	0.176	2.100	2.452
176-2.225	0.176	2.225	2.577
176-2.350	0.176	2.350	2.702
176-2.475	0.176	2.475	2.827
176-2.596	0.176	2.596	2.948
176-2.725	0.176	2.725	3.077
176-2.850	0.176	2.850	3.202
176-2.975	0.176	2.975	3.327
176-3.100	0.176	3.100	3.452
176-3.115	0.176	3.115	3.467
176-3.225	0.176	3.225	3.577
176-3.350	0.176	3.350	3.702
176-3.475	0.176	3.475	3.827
176-3.600	0.176	3.600	3.952
176-3.725	0.176	3.725	4.077
176-3.850	0.176	3.850	4.202
176-3.975	0.176	3.975	4.327
176-4.100	0.176	4.100	4.452
176-4.225	0.176	4.225	4.577
176-4.350	0.176	4.350	4.702
176-4.475	0.176	4.475	4.827
176-4.725	0.176	4.725	5.077
176-4.850	0.176	4.850	5.202
177-2.925	0.177	2.925	3.279
178-165	0.178	0.165	0.521
178-767	0.178	0.767	1.123
176-1.944SS	0.178	1.968	2.324
176-2.145VS	0.178	2.169	2.525
176-2.600SS	0.178	2.622	2.978
179-3.522	0.178	3.510	3.866
176-787SS	0.179	0.799	1.157
179-2.459	0.179	2.459	2.817
176-2.534SS	0.179	2.573	2.931
176-2.725VS	0.179	2.769	3.127
176-5.906SS	0.179	5.996	6.354
180-375	0.180	0.375	0.735

Precision Associates, Inc.
740 N. Washington Ave.
Minneapolis, MN 55401

Phone: 612-333-7464
Fax: 612-342-2417
Toll: 800-394-6590

www.PrecisionAssoc.com



O-Rings Special Size



Mold IDen	C/S	ID	OD (Ref)
180-429	0.180	0.429	0.789
180-1.402	0.180	1.402	1.762
180-1.600	0.180	1.600	1.960
181-4.488	0.181	4.488	4.850
184-417	0.184	0.417	0.785
185-840	0.185	0.840	1.210
185-2.187	0.185	2.187	2.557
185-3.260	0.185	3.260	3.630
186-4.095SS	0.186	4.107	4.479
187-8.553	0.186	8.524	8.896
187-609	0.187	0.609	0.983
185-625SS	0.187	0.632	1.006
187-1.088	0.187	1.088	1.462
187-2.125	0.187	2.125	2.499
187-2.272	0.187	2.272	2.646
187-2.375	0.187	2.375	2.749
187-2.562	0.187	2.562	2.936
187-3.312	0.187	3.312	3.686
187-130ES	0.188	0.130	0.506
188-218	0.188	0.218	0.594
188-4.976	0.188	4.600	4.976
189-5.650	0.188	5.631	6.007
190-280	0.190	0.280	0.660
190-638	0.190	0.638	1.018
193-1.158	0.193	1.158	1.544
190-870SS	0.194	0.887	1.275
195-235	0.195	0.235	0.625
195-938	0.195	0.938	1.328
197-20.669	0.196	20.600	20.992
197-20.670	0.196	20.601	20.993
197-276	0.197	0.276	0.670
197-1.230	0.197	1.230	1.624
197-2.921	0.197	2.921	3.315
197-4.921	0.197	4.921	5.315
197-5.197	0.197	5.197	5.591
197-14.764	0.197	14.764	15.158
197-984VS	0.198	0.988	1.384
197-17.520VS	0.199	17.680	18.078
197-20.669VS	0.199	20.936	21.334
197-5.708VS	0.200	5.781	6.181
199-8.029ES	0.200	8.083	8.483
203-875	0.203	0.875	1.281
202-9.598VS	0.203	9.641	10.047
203-3.375	0.204	3.384	3.792
210-5.450	0.208	5.394	5.810

Mold IDen	C/S	ID	OD (Ref)
209-2.587	0.209	2.587	3.005
209-2.592	0.209	2.592	3.010
209-12.413	0.209	12.413	12.831
210-799	0.210	0.799	1.219
210-1.187	0.210	1.187	1.607
210-1.200	0.210	1.200	1.620
210-1.260	0.210	1.260	1.680
210-1.335	0.210	1.334	1.754
210-1.537	0.210	1.537	1.957
210-1.772	0.210	1.772	2.192
210-1.787	0.210	1.787	2.207
210-1.912	0.210	1.912	2.332
210-1.950	0.210	1.950	2.370
210-1.975PL	0.210	1.975	2.395
210-2.162	0.210	2.162	2.582
210-3.640	0.210	3.640	4.060
210-4.304	0.210	4.304	4.724
210-6.350	0.210	6.350	6.770
210-6.666	0.210	6.666	7.086
210-8.641	0.210	8.641	9.061
210-10.115ES	0.210	10.141	10.561
210-10.250	0.210	10.250	10.670
210-10.300	0.210	10.300	10.720
210-12.475	0.210	12.475	12.895
210-13.475	0.210	13.475	13.895
210-15.475	0.210	15.475	15.895
210-16.830	0.210	16.830	17.250
210-19.200	0.210	19.200	19.620
210-24.625	0.210	24.625	25.045
210-26.940	0.210	26.940	27.360
210-1.373VS	0.211	1.379	1.801
210-3.640SS	0.212	3.678	4.102
210-10.190SS	0.212	10.296	10.720
210-13.375SS	0.212	13.514	13.938
210-22.940VS	0.212	23.178	23.602
210-25.580VS	0.212	25.846	26.270
210-29.880VS	0.212	30.190	30.614
213-1.057	0.213	1.057	1.483
212-1.060VS	0.213	1.065	1.491
213-1.372	0.213	1.372	1.798
215-950	0.215	0.950	1.380
215-1.147	0.215	1.147	1.577
215-1.364	0.215	1.364	1.794
215-7.581	0.215	7.571	8.001
215-9.837	0.215	9.837	10.267

Precision Associates, Inc.

740 N. Washington Ave.
Minneapolis, MN 55401

30

Phone: 612-333-7464

Fax: 612-342-2417

Toll: 800-394-6590

www.PrecisionAssoc.com



O-Rings

Special Size



Mold IDen	C/S	ID	OD (Ref)
215-10.060	0.215	10.060	10.490
215-2.231ES	0.216	2.241	2.673
217-2.362	0.217	2.362	2.796
218-578	0.218	0.578	1.014
219-4.750	0.219	4.750	5.188
220-4.475	0.220	4.475	4.915
220-2.975VS	0.222	3.003	3.447
223-813SS	0.224	0.815	1.263
224-2.052	0.224	2.052	2.500
224-2.362	0.224	2.362	2.810
224-3.724	0.224	3.724	4.172
224-4.098	0.224	4.098	4.546
224-6.075	0.224	6.075	6.523
224-6.783	0.224	6.783	7.231
224-8.240	0.224	8.240	8.688
224-13.252	0.224	13.252	13.700
224-14.146	0.224	14.146	14.594
225-14.900NS	0.224	14.836	15.284
225-1.595PL	0.225	1.595	2.045
225-1.745	0.225	1.745	2.195
224-1.941VS	0.226	1.959	2.411
225-15.500SS	0.227	15.646	16.100
229-1.099SS	0.230	1.103	1.563
230-3.475VS	0.233	3.521	3.987
234-500	0.234	0.500	0.968
234-1.485	0.234	1.485	1.953
234-1.493	0.234	1.493	1.961
231-1.500VS	0.234	1.519	1.987
235-975	0.235	0.975	1.445
237-1.848	0.237	1.848	2.322
237-1.347SS	0.238	1.352	1.828
237-1.597SS	0.238	1.603	2.079
235-1.845SS	0.238	1.869	2.345
238-2.458	0.238	2.458	2.934
236-7.441	0.238	7.509	7.985
241-4.475	0.241	4.475	4.957
241-4.850	0.241	4.850	5.332
241-5.725	0.241	5.725	6.207
241-6.225	0.241	6.225	6.707
241-6.975	0.241	6.975	7.457
241-7.225	0.241	7.225	7.707
241-7.475	0.241	7.475	7.957
241-7.725	0.241	7.725	8.207
241-7.975	0.241	7.975	8.457
243-500	0.243	0.500	0.986

Mold IDen	C/S	ID	OD (Ref)
241-8.475SS	0.243	8.546	9.032
241-9.975VS	0.244	10.118	10.606
243-2.060VS	0.245	2.077	2.567
245-2.235	0.245	2.235	2.725
245-6.015	0.245	6.015	6.505
240-17.250SS	0.245	17.581	18.071
241-9.475SS	0.247	9.713	10.207
248-15.000	0.247	14.950	15.444
248-3.575	0.248	3.575	4.071
250-1.062NS	0.249	1.056	1.554
250-469	0.250	0.469	0.969
250-750	0.250	0.750	1.250
250-980	0.250	0.980	1.480
250-1.240	0.250	1.240	1.740
250-1.438	0.250	1.438	1.938
250-1.562	0.250	1.562	2.062
250-1.660	0.250	1.660	2.160
250-1.750	0.250	1.750	2.250
250-1.860	0.250	1.860	2.360
250-2.200	0.250	2.200	2.700
250-2.725	0.250	2.725	3.225
250-2.750	0.250	2.750	3.250
250-3.250	0.250	3.250	3.750
250-4.375	0.250	4.375	4.875
249-635SS	0.251	0.640	1.142
250-25.375VS	0.252	25.614	26.118
252-4.905VS	0.255	4.968	5.478
256-10.846SS	0.255	10.801	11.311
256-12.205	0.255	12.164	12.674
256-6.181	0.256	6.172	6.684
259-1.375	0.259	1.375	1.893
260-2.476	0.260	2.473	2.993
260-6.325	0.260	6.325	6.845
258-6.179VS	0.261	6.258	6.780
258-6.437VS	0.261	6.520	7.042
260-10.425SS	0.262	10.523	11.047
264-1.406	0.264	1.406	1.934
268-2.763	0.268	2.767	3.303
270-470	0.270	0.470	1.010
270-8.240SS	0.273	8.336	8.882
270-9.421SS	0.273	9.531	10.077
275-16.750	0.274	16.694	17.242
275-687	0.275	0.687	1.237
275-859	0.275	0.859	1.409
275-945	0.275	0.945	1.495

Precision Associates, Inc.
740 N. Washington Ave.
Minneapolis, MN 55401

Phone: 612-333-7464
Fax: 612-342-2417
Toll: 800-394-6590

www.PrecisionAssoc.com



O-Rings

Special Size



Mold IDen	C/S	ID	OD (Ref)
275-1.050	0.275	1.050	1.600
275-1.100	0.275	1.100	1.650
275-1.100VS	0.275	1.114	1.664
275-1.225	0.275	1.225	1.775
275-1.655	0.275	1.655	2.205
275-2.250	0.275	2.250	2.800
275-6.600	0.275	6.600	7.150
275-8.225	0.275	8.225	8.775
275-8.725	0.275	8.725	9.275
275-10.725	0.275	10.725	11.275
275-12.000	0.275	12.000	12.550
275-27.485	0.275	27.485	28.035
275-28.801	0.275	28.801	29.351
275-1.745VS	0.276	1.751	2.303
275-29.331ES	0.276	29.520	30.072
275-8.350ES	0.277	8.404	8.958
281-750	0.281	0.750	1.312
281-2.391	0.281	2.391	2.953
281-3.844	0.281	3.844	4.406
281-1.250NS	0.282	1.256	1.820
282-1.986VS	0.283	1.995	2.561
282-2.490VS	0.283	2.499	3.065
285-340	0.285	0.340	0.910
285-2.027	0.285	2.027	2.597
286-1.407	0.286	1.407	1.979
285-1.735VS	0.286	1.741	2.313
290-11.475ES	0.291	11.532	12.114
288-14.250SS	0.293	14.515	15.101
290-16.625SS	0.294	16.830	17.418
299-1.410	0.299	1.410	2.008
300-957	0.300	0.957	1.557
300-1.220	0.300	1.220	1.820
300-3.475	0.300	3.475	4.075
312-2.312	0.311	2.304	2.926
312-2.812	0.311	2.803	3.425
312-16.690	0.311	16.690	17.312
312-875	0.312	0.875	1.499
312-1.594	0.312	1.594	2.218
312-8.750	0.312	8.750	9.374
313-2.350	0.313	2.350	2.976
310-3.136SS	0.313	3.165	3.791
313-18.000	0.313	18.000	18.626
312-2.875SS	0.315	2.905	3.535
312-3.300SS	0.315	3.331	3.961
315-4.776	0.315	4.776	5.406

Mold IDen	C/S	ID	OD (Ref)
312-6.700VS	0.315	6.770	7.400
312-4.700ES	0.316	4.754	5.386
312-12.750SS	0.316	12.899	13.531
319-2.411	0.319	2.411	3.049
139-6.630ES	0.319	6.646	7.284
321-937	0.321	0.937	1.579
323-8.898	0.323	8.898	9.544
331-8.197	0.331	8.197	8.859
328-8.500VS	0.331	8.569	9.231
335-2.027	0.335	2.027	2.697
339-14.189	0.338	14.128	14.804
338-15.410	0.338	15.410	16.086
339-11.654	0.339	11.638	12.316
341-25.984	0.339	25.846	26.524
340-25.275VS	0.344	25.599	26.287
345-580	0.345	0.580	1.270
346-20.125	0.346	20.125	20.817
351-10.270	0.351	10.270	10.972
352-20.126	0.352	20.098	20.802
349-10.199VS	0.354	10.335	11.043
357-1.719	0.357	1.719	2.433
360-440	0.360	0.440	1.160
370-12.157	0.368	12.081	12.817
370-2.982	0.370	2.982	3.722
370-12.106	0.370	12.106	12.846
375-4.250	0.374	4.244	4.992
375-1.625	0.375	1.625	2.375
375-1.906	0.375	1.906	2.656
375-2.375	0.375	2.375	3.125
375-2.500	0.375	2.500	3.250
375-2.608	0.375	2.608	3.358
375-2.625	0.375	2.625	3.375
375-2.930	0.375	2.930	3.680
375-3.622	0.375	3.622	4.372
375-4.006	0.375	4.006	4.756
375-5.750	0.375	5.750	6.500
375-7.500	0.375	7.500	8.250
375-7.733	0.375	7.733	8.483
375-8.159	0.375	8.159	8.909
375-8.250	0.375	8.250	9.000
375-16.625	0.375	16.625	17.375
375-4.438ES	0.376	4.449	5.201
375-12.250VS	0.376	12.269	13.021
375-3.325SS	0.377	3.346	4.100
375-5.000SS	0.377	5.023	5.777

Precision Associates, Inc.

740 N. Washington Ave.
Minneapolis, MN 55401

32

Phone: 612-333-7464

Fax: 612-342-2417

Toll: 800-394-6590

www.PrecisionAssoc.com



O-Rings Special Size



Mold IDen	C/S	ID	OD (Ref)
375-7.125SS	0.377	7.157	7.911
375-27.250VS	0.377	27.399	28.153
375-4.250VS	0.379	4.294	5.052
375-7.324SS	0.379	7.409	8.167
375-8.130SS	0.379	8.225	8.983
375-8.505SS	0.379	8.604	9.362
375-9.312SS	0.379	9.421	10.179
375-9.881SS	0.379	9.996	10.754
375-10.690SS	0.379	10.728	11.486
375-12.750SS	0.379	12.899	13.657
375-9.600	0.380	9.690	10.450
374-1.102VS	0.380	1.121	1.881
380-6.640	0.380	6.640	7.400
380-6.688	0.380	6.688	7.448
380-10.875	0.380	10.875	11.635
375-5.850VS	0.381	5.950	6.712
375-6.650VS	0.381	6.763	7.525
380-8.812ES	0.381	8.834	9.596
375-9.250SS	0.384	9.464	10.232
388-8.380	0.388	8.380	9.156
400-3.850	0.400	3.850	4.650
406-844	0.406	0.844	1.656
415-580	0.415	0.580	1.410
430-1.438	0.430	1.438	2.298
437-1.500	0.437	1.500	2.374
437-2.875	0.437	2.875	3.749
438-4.938	0.438	4.938	5.814
450-1.937	0.450	1.937	2.837
455-4.866	0.455	4.866	5.776
455-6.308	0.455	6.308	7.218
500-6.264	0.497	6.225	7.219
500-1.500	0.500	1.500	2.500
500-1.875	0.500	1.875	2.875
500-3.500	0.500	3.500	4.500
500-3.675	0.500	3.675	4.675
500-3.937	0.500	3.937	4.937
500-4.500	0.500	4.500	5.500
500-5.000	0.500	5.000	6.000
500-5.562	0.500	5.562	6.562
500-6.000	0.500	6.000	7.000
500-6.625	0.500	6.625	7.625
500-14.156	0.500	14.156	15.156
500-19.411	0.500	19.411	20.411

Mold IDen	C/S	ID	OD (Ref)
500-7.250ES	0.506	7.339	8.351
500-5.750VS	0.509	5.849	6.867
500-7.250VS	0.518	7.505	8.541
520-6.519	0.520	6.519	7.559
625-2.250	0.625	2.250	3.500
625-4.812	0.625	4.812	6.062
625-8.000	0.625	8.000	9.250
625-8.625	0.625	8.625	9.875
625-13.875SS	0.630	14.101	15.361
631-14.101	0.631	14.101	15.363
750-1.690	0.750	1.690	3.190
1.000-14.430	0.993	14.325	16.311
1.000-15.735	1.000	15.735	17.735
1.062-5.125	1.062	5.125	7.249



740 North Washington Ave.
Minneapolis, MN 55401-1188

Toll Free: 1-800-394-6590

612-333-7464

Sales: 612-334-9190

FAX: 612-342-2417

Info@PrecisionAssociates.com

Ask us about our complete line of product literature:

- **O-Rings**
- **U-Cups**
- **V-Rings**
- **X-Rings**
- **Rod Wipers**
- **Multiseal[®] Low Friction Seals**
- **Kurv-Bak[™] Hard Rubber Back-Up Rings**
- **Rubber Balls**
- **Custom Moldings**

After 50 years in the rubber business, we've learned to be flexible. We'll bend over backwards to design custom solutions that meet your needs *precisely*. PAI is the company you can trust for rubber seal solutions YOUR WAY!

- **Over 900 different compounds**
- **More than 2,000 O-Ring sizes**
- **Custom molding**
- **In-house tooling**
- **98.8+% on-time delivery**

www.PrecisionAssoc.com